



6" SQUARE DIRECT FOCUSED ILLUMINATION



CO618SQXT, CO624SQXT - WALL MOUNT

APPLICATION

6" square x 18" or 24" high direct XT series cylinder luminaire for accent and general illumination.

FEATURES

Spectrum's Cylinder series provides traditional architectural style with high performance and energy efficient illumination. Rugged design with flexible mounting, finish and LED options make these extremely versatile fixtures. Quick change LED module with interchangeable optics for job site flexibility and fixture upgrade.

FINISH

Multi-stage polyester powder-coat process applied on our dedicated paint lines. See mounting and color pages for standard finishes. All exposed materials are chromate pretreated to resist corrosion.

ELECTRONICS

LED system features Xicato LED module with proprietary phosphor technology that provides consistent stable color with CCT control of +/- 100K over life of the light engine. Base CRI is 83 with 2-step MacAdam Ellipse binning. High CRI is 98 with 1 x 2-step MacAdam Ellipse binning. Variety of electronic 120V/277V and dimming drivers. 1 or 2 circuit operation.

CONSTRUCTION

Fabricated seamless aluminum fixture housing. Silicone gasket seals optical chamber. Specular primary optical reflectors provide high efficiency illumination. Impact resistant tempered glass lenses. Stainless steel hardware with galvanized steel brackets to resist corrosion. Die-cast aluminum trim.

CODE COMPLIANCE

BAA compliant. ETL certified to meet US and Canadian standards. Suitable for dry or damp locations. Wet Location Option. Manufactured and tested to UL standards No. 1598/8750.

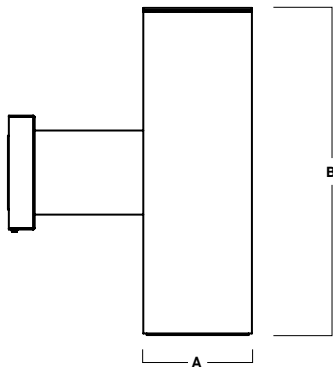

SERIES	A	B
CO618SQXT	6.0	18.0
CO624SQXT	6.0	24.0

Fixture Weight: 17.2 lbs

LUMENS / WATTAGE DATA				
PART NUMBER	SOURCE LUMENS ¹	DELIVERED LUMENS ²	SYSTEM WATTS ³	LPW
CO618SQDXT10L	1000	837	9.1	92
CO618SQDXT13L	1300	1128	13	87
CO618SQDXT20L	2000	1735	21.7	80
CO618SQDXT30L	3000	2603	32.6	80

SERIES	LUMENS ¹	CCT	OPTICS	DRIVER / DIMMING ⁷	OPTIONS	TRIM	MOUNTING ¹²	FINISH ¹³
CO618SQXT 6" x 18" Cylinder	10L	1000 Lm	83 CRI	XN ^{5/6} 13°	EX Electronic Driver, 120V/277V	WL Wet Location	TCY ⁸ Same Color as Cylinder TPT Platinum Silver TCC Custom Color	MW ¹⁴ Matte White MB ¹⁴ Matte Black PT ¹⁴ Platinum Silver CC Custom Color
	13L	1300 Lm	27K 2700K	ND 21°				
CO624SQXT 6" x 24" Cylinder	20L	2000 Lm	30K 3000K	MD 39°	DS10X 10%, 0-10V, 120V/277V DS2W1 ELV/MLV, 120V			
	30L	3000 Lm	35K 3500K	WD 44°				
			40K 4000K	XW 56°				
			98 CRI ⁴					
		27HK 2700K					EMERGENCY BATTERY OPTIONS	
		30HK 3000K					EMRM 7W Remote EM	
		35HK 3500K					EMEN 7W Remote with Enclosure	
		40HK 4000K						
						GL ¹⁰ Clear Glass Lens SO ¹¹ Micro Prism Solite™ Lens		

EXAMPLE: CO624SQXT20L35KWDEXTCYSOWM5MW

NOTES:
 1 Nominal Source Lumens at Any CCT 2 Nominal Delivered Lumens at 83 CRI at Any CCT with MD-TCY-SO-MW 3 At 83 CRI 4 20L Max 5 13L Max 6 XN not Available with 98 CRI Option 7 Contact Factory for Additional Options
 8 Standard Finish 9 Not Available with WL 10 Standard Lens for XN, ND 11 Standard Lens for MD, WD, XW 12 See Mounting Page for Details on Components and Finishes 13 Reference Color Sheet Located on Product Webpage for Full List of Available Colors/Consult Factory for Special Finishes 14 Standard Finishes



PROJECT: _____
 TYPE: _____



Dimensions and values shown are nominal. Spectrum Lighting continually works to improve products and reserves the right to make changes which may alter the performance or appearance of products.

6" SQUARE DIRECT

FOCUSED ILLUMINATION / FIXTURE OPTIONS



SERIES SIZES

C0618SQXT

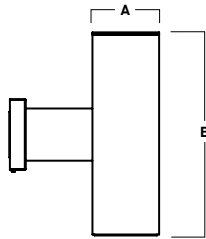

A	B
6.0	18.0
152.4 mm	457.2 mm

C0624SQXT

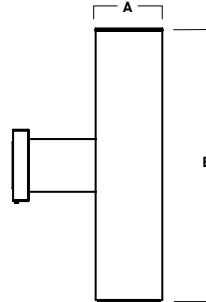
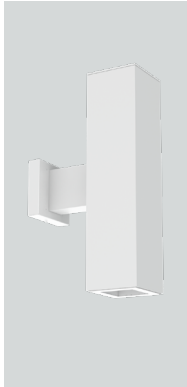

A	B
6.0	24.0
152.4 mm	609.6 mm

STANDARD FINISHES

MW
MATTE WHITE



MB
MATTE BLACK

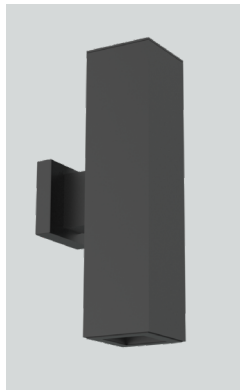

PT
PLATINUM SILVER

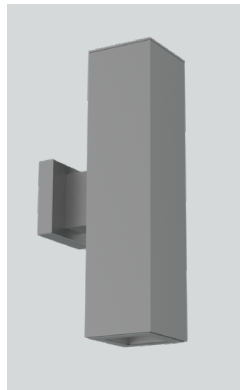

WALL MOUNT DETAIL

WM3
WALL MOUNT 3" EXTENSION

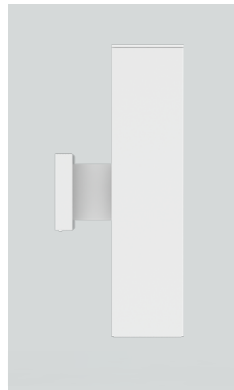

FRONT VIEW

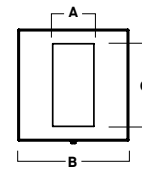

SIDE VIEW

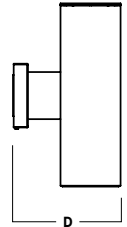

A	B	C	D
2.4	6.4	4.7	10.7
61.0 mm	162.6 mm	119.4 mm	271.8 mm

WM5
WALL MOUNT 5" EXTENSION

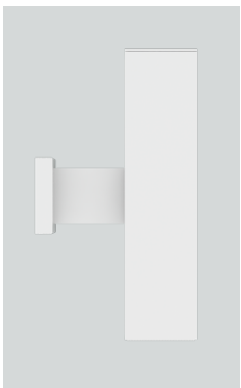

FRONT VIEW

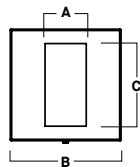

SIDE VIEW

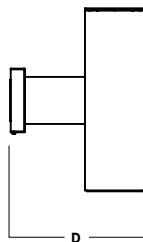

A	B	C	D
2.4	6.4	4.7	13.4
61.0 mm	162.6 mm	119.4 mm	340.4 mm

EMERGENCY BATTERY OPTIONS

EMRM* - 7W REMOTE EMERGENCY BATTERY
(50' MAX)

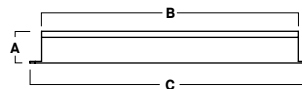

A	B	C
1.3	12.6	13.0

EMEN* - 7W REMOTE EMERGENCY BATTERY
WITH ENCLOSURE (50' MAX)

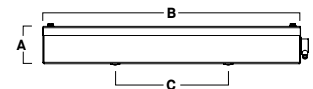

A	B	C
2.0	17.0	6.2

*OTHER EM BATTERY SIZES AVAILABLE, CONSULT FACTORY

6" ROUND DIRECT

FOCUSED ILLUMINATION / PHOTOMETRIC DATA



C06xxSQXT 13L XN 35K XX TCY GL MW

CANDLEPOWER CURVE TEST SP-01200	INTENSITY CANDELA 0° AZIMUTH	ZONAL LUMENS	SINGLE UNIT: PERFORMANCE DIRECT FOOTCANDLES BASED ON DOWNLIGHT ONLY				MULTIPLE UNITS: PERFORMANCE 80/50/20% REFLECTANCES INITIAL FOOTCANDLES AND WATTS PER SQUARE FOOT					
			Mounting Height AFF	FC at Center on Floor	Beam Diameter	FC at Beam Edge	Ceiling Height	Fixture Spacing	RCR 6		RCR 8	
	0°	0° - 10° 627 55%	12'	98 fc	2.6'	48 fc	22'	4"	71	1.18	67	1.17
	5°	0° - 20° 916 80%	14'	72 fc	3.0'	35 fc	26'	5"	49	0.81	46	0.80
	15°	0° - 30° 1096 96%	16'	55 fc	3.4'	27 fc	32'	6"	31	0.51	29	0.50
	25°	0° - 40° 1153 101%	20'	35 fc	4.3'	17 fc	Delivered Illuminance Rating: (DIR)					
	35°	0° - 60° 1173 103%	24'	25 fc	5.1'	12 fc	3' Suspension Length to luminous aperture Square rooms used for multiple units: RCR 6: Length & Width = Ceiling Ht. - 3.0' x 1.66 RCR 8: Length & Width = Ceiling Ht. - 3.0' x 1.25					
	45°	0° - 80° 1186 104%	28'	18 fc	6.0'	9 fc	* Average Footcandles at 0' Above Floor					
	55°	0° - 90° 1140 100%	32'	14 fc	6.8'	7 fc	** Exceeds Spacing Ratio by 5%					
	90°	Total 1140 100%	36'	11 fc	7.7'	5 fc	*** Exceeds Spacing Ratio by 3%					

Delivered Lumens: 1188
Luminaire Watts: 18.4
LER: 64.57

Beam Angle: 12°
Spacing Ratio: 0.20

Lumen Multiplier: 10L x 0.74
CCT Multiplier: Same for all available CCTs

CR1: 83

C06xxSQXT 30L ND 35K XX TCY GL MW

CANDLEPOWER CURVE TEST SP-01201_M-30L	INTENSITY CANDELA 0° AZIMUTH	ZONAL LUMENS	SINGLE UNIT: PERFORMANCE DIRECT FOOTCANDLES BASED ON DOWNLIGHT ONLY				MULTIPLE UNITS: PERFORMANCE 80/50/20% REFLECTANCES INITIAL FOOTCANDLES AND WATTS PER SQUARE FOOT					
			Mounting Height AFF	FC at Center on Floor	Beam Diameter	FC at Beam Edge	Ceiling Height	Fixture Spacing	RCR 4		RCR 6	
	0°	0° - 10° 951 32%	8'	208 fc	3.0'	99 fc	18'	4'	187	2.14	153	1.89
	5°	0° - 20° 2050 69%	10'	133 fc	3.7'	63 fc	22'	5'	107	1.23	88	1.09
	15°	0° - 30° 2680 90%	12'	92 fc	4.4'	44 fc	26'	6'	70	0.79	82	1.01
	25°	0° - 40° 2875 97%	14'	68 fc	5.2'	32 fc	Delivered Illuminance Rating: (DIR)					
	35°	0° - 60° 2956 99%	16'	52 fc	5.9'	25 fc	3' Suspension Length to luminous aperture Square rooms used for multiple units: RCR 4: Length & Width = Ceiling Ht. - 5.5' x 2.50 RCR 6: Length & Width = Ceiling Ht. - 5.5' x 1.66					
	45°	0° - 80° 3012 101%	20'	33 fc	7.4'	16 fc	* Average Footcandles at 2.5' Above Floor					
	55°	0° - 90° 2988 100%	24'	23 fc	8.9'	11 fc						
	90°	Total 2988 100%	28'	17 fc	10.4'	8 fc						

Delivered Lumens: 3018
Luminaire Watts: 32.6
LER: 92.58

CP at 0° (Nadir): 13286

Beam Angle: 21°
Spacing Ratio: 0.34

Lumen Multiplier: 10L x 0.32, 13L x 0.43, 20L x 0.67
CCT Multiplier: Same for all available CCTs

CR1: 83

C06xxSQXT 30L MD 35K XX TCY SO MW

CANDLEPOWER CURVE TEST SP-01202_M-30L	INTENSITY CANDELA 0° AZIMUTH	ZONAL LUMENS	SINGLE UNIT: PERFORMANCE DIRECT FOOTCANDLES BASED ON DOWNLIGHT ONLY				MULTIPLE UNITS: PERFORMANCE 80/50/20% REFLECTANCES INITIAL FOOTCANDLES AND WATTS PER SQUARE FOOT					
			Mounting Height AFF	FC at Center on Floor	Beam Diameter	FC at Beam Edge	Ceiling Height	Fixture Spacing	RCR 3		RCR 5	
	0°	0° - 10° 462 18%	8'	81 fc	5.6'	34 fc	18'	6'	71	0.92	58	0.83
	5°	0° - 20° 1391 53%	10'	52 fc	7.0'	22 fc	22'	8'	41	0.53	33	0.48
	15°	0° - 30° 2152 83%	12'	36 fc	8.4'	15 fc	26'	10'	26	0.34	21	0.31
	25°	0° - 40° 2433 93%	14'	26 fc	9.8'	11 fc	Delivered Illuminance Rating: (DIR)					
	35°	0° - 60° 2552 98%	16'	20 fc	11.2'	8 fc	3' Suspension Length to luminous aperture Square rooms used for multiple units: RCR 3: Length & Width = Ceiling Ht. - 5.5' x 3.33 RCR 5: Length & Width = Ceiling Ht. - 5.5' x 2.00					
	45°	0° - 80° 2612 100%	20'	13 fc	14.1'	5 fc	* Average Footcandles at 2.5' Above Floor					
	55°	0° - 90° 2594 100%	24'	9 fc	16.9'	4 fc						
	90°	Total 2594 100%	28'	7 fc	19.7'	3 fc						

Delivered Lumens: 2620
Luminaire Watts: 32.6
LER: 80.37

CP at 0° (Nadir): 5166

Beam Angle: 39°
Spacing Ratio: 0.61

Lumen Multiplier: 10L x 0.32, 13L x 0.43, 20L x 0.67
CCT Multiplier: Same for all available CCTs

CR1: 83

6" ROUND DIRECT

FOCUSED ILLUMINATION / PHOTOMETRIC DATA



C06xxSQXT 30L WD 35K XX TCY SO MW

CANDLEPOWER CURVE TEST SP-01203_M-30L	INTENSITY CANDELA 0° AZIMUTH	ZONAL LUMENS	SINGLE UNIT: PERFORMANCE DIRECT FOOTCANDLES BASED ON DOWNLIGHT ONLY				MULTIPLE UNITS: PERFORMANCE 80/50/20% REFLECTANCES INITIAL FOOTCANDLES AND WATTS PER SQUARE FOOT						
			Mounting Height AFF	FC at Center on Floor	Beam Diameter	FC at Beam Edge	Ceiling Height	Fixture Spacing	RCR 3		RCR 5		
	0°	0° - 10° 392 15%	8'	66 fc	6.4'	26 fc	18'	6'	69	0.92	56	0.83	
	0°	0° - 20° 1247 49%	10'	42 fc	8.0'	17 fc	22'	8'	40	0.53	32	0.48	
	5°	0° - 30° 2028 80%	12'	29 fc	9.6'	12 fc	26'	10'	26	0.34	21	0.31	
	15°	0° - 40° 2352 92%	14'	22 fc	11.3'	9 fc	Delivered Illuminance Rating: (DIR)						
	25°	0° - 60° 2496 98%	16'	17 fc	12.9'	7 fc	75 FC per W/Sq. Ft. 67 FC per W/Sq. Ft.						
	35°	0° - 80° 2555 100%	20'	11 fc	16.1'	4 fc	3' Suspension Length to luminous aperture Square rooms used for multiple units: RCR 3: Length & Width = Ceiling Ht. - 5.5' x 3.33 RCR 5: Length & Width = Ceiling Ht. - 5.5' x 2.00 * Average Footcandles at 2.5' Above Floor						
	45°	0° - 90° 2537 100%	24'	7 fc	19.3'	3 fc							
	55°	0° - 90° 2537 100%	28'	5 fc	22.5'	2 fc							
	90°	2	Total 2537 100%										

Delivered Lumens: 2563
Luminaire Watts: 32.6
LER: 78.62

CP at 0° (Nadir): 4230
CRI: 83

Beam Angle: 44°
Spacing Ratio: 0.69

Lumen Multiplier: 10L x 0.32, 13L x 0.43, 20L x 0.67
CCT Multiplier: Same for all available CCTs

C06xxSQXT 30L XW 35K EX TCY SO MW

CANDLEPOWER CURVE TEST SP-01199_M-30L	INTENSITY CANDELA 0° AZIMUTH	ZONAL LUMENS	SINGLE UNIT: PERFORMANCE DIRECT FOOTCANDLES BASED ON DOWNLIGHT ONLY				MULTIPLE UNITS: PERFORMANCE 80/50/20% REFLECTANCES INITIAL FOOTCANDLES AND WATTS PER SQUARE FOOT						
			Mounting Height AFF	FC at Center on Floor	Beam Diameter	FC at Beam Edge	Ceiling Height	Fixture Spacing	RCR 2		RCR 4		
	0°	0° - 10° 301 13%	8'	49 fc	7.5'	18 fc	18'	8'	39	0.53	34	0.53	
	0°	0° - 20° 1024 43%	10'	32 fc	9.4'	12 fc	22'	10'	22	0.31	20	0.31	
	5°	0° - 30° 1784 76%	12'	22 fc	11.3'	8 fc	26'	12'	14	0.20	13	0.20	
	15°	0° - 40° 2126 90%	14'	16 fc	13.2'	6 fc	Delivered Illuminance Rating: (DIR)						
	25°	0° - 60° 2308 98%	16'	12 fc	15.1'	5 fc	73 FC per W/Sq. Ft. 64 FC per W/Sq. Ft.						
	35°	0° - 80° 2364 100%	20'	8 fc	18.9'	3 fc	3' Suspension Length to luminous aperture Square rooms used for multiple units: RCR 2: Length & Width = Ceiling Ht. - 5.5' x 5.00 RCR 4: Length & Width = Ceiling Ht. - 5.5' x 2.50 * Average Footcandles at 2.5' Above Floor						
	45°	0° - 90° 2370 100%	24'	5 fc	22.6'	2 fc							
	55°	0° - 90° 2370 100%	28'	4 fc	26.4'	1 fc							
	90°	3	Total 2370 100%										

Delivered Lumens: 2370
Luminaire Watts: 32.6
LER: 72.70

CP at 0° (Nadir): 3161
CRI: 83

Beam Angle: 50°
Spacing Ratio: 0.81

Lumen Multiplier: 10L x 0.32, 13L x 0.43, 20L x 0.67
CCT Multiplier: Same for all available CCTs