

6" SQUARE DIRECT / INDIRECT FOCUSED ILLUMINATION

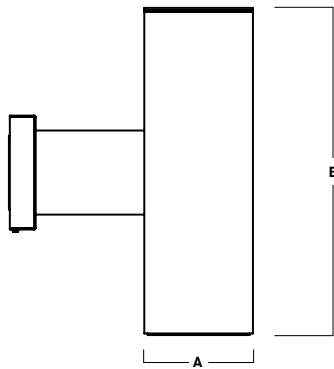

SERIES	A	B
CO618SQUDXT	6.0	18.0
CO624SQUDXT	6.0	24.0

Fixture Weight: 17.2 lbs

CO618SQUDXT, CO624SQUDXT - WALL MOUNT

APPLICATION

6" square x 18" or 24" high direct / indirect XT series cylinder luminaire for accent and general illumination.

FEATURES

Spectrum's Cylinder series provides traditional architectural style with high performance and energy efficient illumination. Rugged design with flexible mounting, finish and LED options make these extremely versatile fixtures. Quick change LED module with interchangeable optics for job site flexibility and fixture upgrade.

FINISH

Multi-stage polyester powder-coat process applied on our dedicated paint lines. See mounting and color pages for standard finishes. All exposed materials are chromate pre-treated to resist corrosion.

ELECTRONICS

LED system features Xicato LED module with proprietary phosphor technology that provides consistent stable color with CCT control of +/- 100K over life of the light engine. Base CRI is 83 with 2-step MacAdam Ellipse binning. High CRI is 98 with 1 x 2-step MacAdam Ellipse binning. Variety of electronic 120V/277V and dimming drivers. 1 or 2 circuit operation.

CONSTRUCTION

Fabricated seamless aluminum fixture housing. Silicone gasket seals optical chamber. Specular primary optical reflectors provide high efficiency illumination. Impact resistant tempered glass lenses. Stainless steel hardware with galvanized steel brackets to resist corrosion. Die-cast aluminum trim.

CODE COMPLIANCE

BAA compliant. ETL certified to meet US and Canadian standards. Suitable for dry or damp locations. Wet Location Option. Manufactured and tested to UL standards No. 1598/8750.

LUMENS / WATTAGE DATA				
PART NUMBER	SOURCE LUMENS	DELIVERED LUMENS ²	SYSTEM WATTS ³	LPW
CO6xxSQUDXT10Lx2	2000	1374	18.2	75
CO6xxSQUDXT13Lx2	2600	1852	26.0	71
CO6xxSQUDXT20Lx2	4000	2849	43.4	66

SERIES	UPLIGHT ⁴		DOWNLIGHT		CCT		DRIVER / DIMMING ⁷		OPTIONS ⁸		TRIM		MOUNTING ¹²		FINISH ¹³									
CO618SQUDXT 6" x 18" Cylinder	LUMENS ¹	OPTICS	LUMENS ¹	OPTICS	83 CRI		EX	Electronic Driver, 120V/277V	WL	Wet Location	TCY ⁹	Same Color as Cylinder	WM3	Wall Mount 3" Extension	MW ¹⁵	Matte White								
					10L	1000 Lm											XN ^{5/6}	12°	10L	1000 Lm	ND	21°	30K	3000K
CO624SQUDXT 6" x 24" Cylinder	LUMENS ¹	OPTICS	LUMENS ¹	OPTICS	98 CRI		DO10X	1%, 0-10V, 120V/277V	2CIR	2 Circuit	TCC	Custom Color	EMERGENCY BATTERY OPTIONS		CC	Custom Color								
					20L	2000 Lm							MD	38°			35K	3500K	DS2W1	ELV/MLV, 120V	GL ¹⁰	Clear Glass Lens	EMRM	7W Remote EM
					WD	45°							40K	4000K			SO ¹¹	Micro Prism Solite™ Lens					EMEN	7W Remote with Enclosure
																							XW	58°

EXAMPLE: CO624SQUDXT20LWD20LWD35KEX/TCYSO/WM5/MW

NOTES:
 1 Nominal Source Lumens at Any CCT 2 Nominal Delivered Lumens at 83 CRI at Any CCT with MD-GL, MD-TCY-SO-MW 3 At 83 CRI 4 1/4" Clear Glass Only 5 13L Max 6 XN not Available with 98 CRI Option 7 Contact Factory for Additional Options 8 See Product Options Page for Details 9 Standard Finish 10 Standard Lens for All Indirect and Direct: XN, ND 11 Standard Lens for Direct: MD, WD, XW 12 See Mounting Page for Details on Components and Finishes 13 Reference Color Sheet Located on Product Webpage for Full List of Available Colors 14 Standard Finishes



PROJECT: _____
 TYPE: _____



Dimensions and values shown are nominal. Spectrum Lighting continually works to improve products and reserves the right to make changes which may alter the performance or appearance of products.

6" SQUARE DIRECT / INDIRECT

FOCUSED ILLUMINATION / FIXTURE OPTIONS



SERIES SIZES

CO618SQUDXT

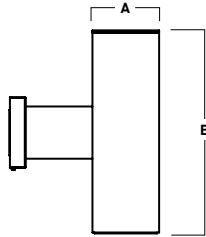

A	B
6.0	18.0
152.4 mm	457.2 mm

CO624SQUDXT

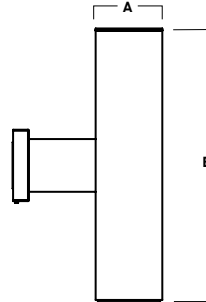
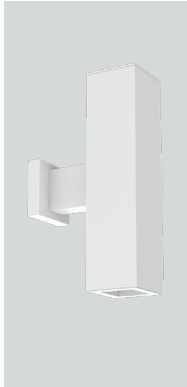

A	B
6.0	24.0
152.4 mm	609.6 mm

STANDARD FINISHES

MW
MATTE WHITE



MB
MATTE BLACK

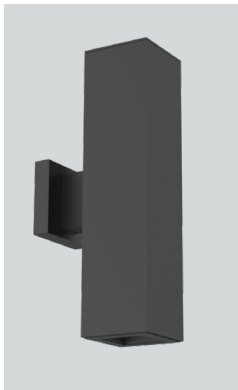

PT
PLATINUM SILVER

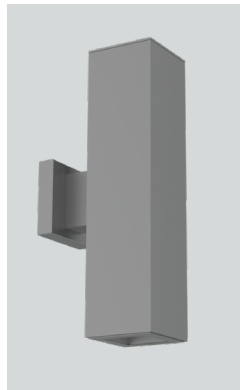

WALL MOUNT DETAIL

WM3
WALL MOUNT 3" EXTENSION

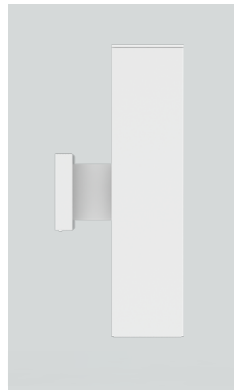

FRONT VIEW

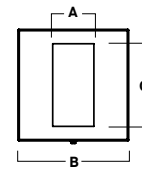

SIDE VIEW

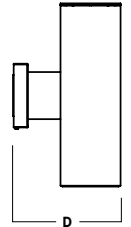

A	B	C	D
2.4	6.4	4.7	10.7
61.0 mm	162.6 mm	119.4 mm	271.8 mm

WM5
WALL MOUNT 5" EXTENSION

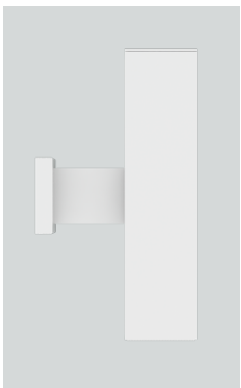

FRONT VIEW

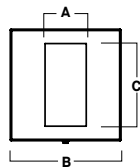

SIDE VIEW

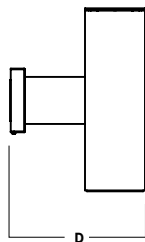

A	B	C	D
2.4	6.4	4.7	13.4
61.0 mm	162.6 mm	119.4 mm	340.4 mm

EMERGENCY BATTERY OPTIONS

EMRM* - 7W REMOTE EMERGENCY BATTERY
(50' MAX)

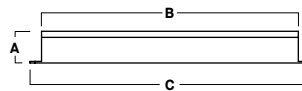

A	B	C
1.3	12.6	13.0

EMEN* - 7W REMOTE EMERGENCY BATTERY
WITH ENCLOSURE (50' MAX)

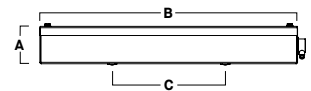

A	B	C
2.0	17.0	6.2

*OTHER EM BATTERY SIZES AVAILABLE, CONSULT FACTORY

6" SQUARE DIRECT / INDIRECT

FOCUSED ILLUMINATION / PHOTOMETRIC DATA



C06xxSQUDXT-13LXNGL-13LXN-xxKEX-TCY-GLMW

13Lx2 XTRA NARROW - 83 CRI

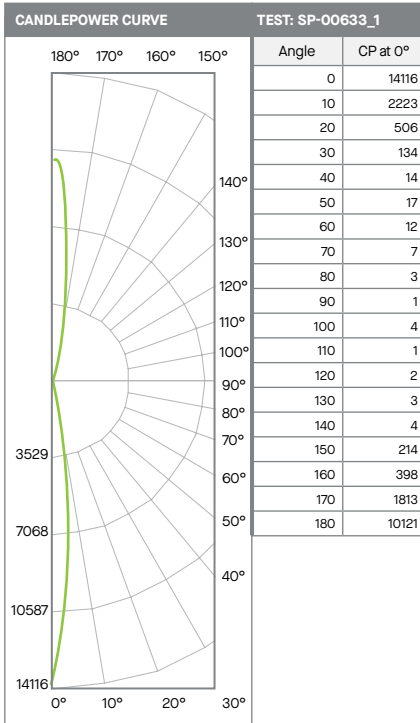

ZONAL LUMENS		
0-20	889	46%
0-40	1127	59%
0-60	1147	60%
0-90	1162	60%
90-120	9	0%
90-150	58	3%
90-180	761	40%
Total Lumens	1923	100%

SINGLE UNIT: PERFORMANCE INITIAL FOOTCANDLES AND BEAM ANGLE DIAMETERS			
Mounting Height*	FC at Center	Diameter of Beam**	FC at Beam**
5.5'	467	1.2'	231
6.5'	334	1.4'	165
7.5'	251	1.6'	124
8.5'	195	1.8'	97
10.0'	141	2.1'	70
12.0'	98	2.5'	48
14.0'	72	2.9'	36
16.0'	55	3.4'	27

SINGLE UNIT: PERFORMANCE INITIAL FOOTCANDLES AND BEAM ANGLE DIAMETERS			
Mounting Distance*	FC at Center	Diameter of Beam**	FC at Beam**
4.0'	882	0.8'	437
5.0'	565	1.0'	280
6.0'	392	1.2'	194
8.0'	221	1.5'	109
10.0'	141	1.9'	70
12.0'	98	2.3'	49
14.0'	72	2.7'	36
16.0'	55	3.1'	27

Delivered Lumens: 1923
Luminaire Watts: 36.8
LER: 52

CP @ 0° (Nadir): 14116
Direct Beam Angle: 12°
Indirect Beam Angle: 11°
CRI: 83

Spacing Ratio: N/A
Output Multipliers: 10L x 0.74

C06xxSQUDXT-20LNDGL-20LND-xxKEX-TCY-GLMW

20Lx2 NARROW - 83 CRI

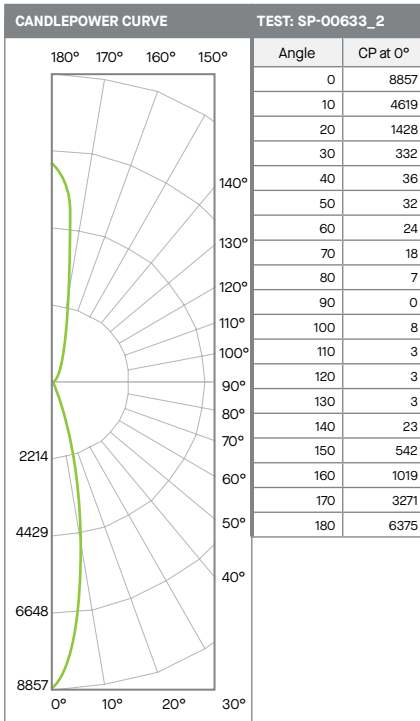

ZONAL LUMENS		
0-20	1346	40%
0-40	1900	56%
0-60	1954	58%
0-90	1996	59%
90-120	16	0%
90-150	140	4%
90-180	1391	41%
Total Lumens	3386	100%

SINGLE UNIT: PERFORMANCE INITIAL FOOTCANDLES AND BEAM ANGLE DIAMETERS			
Mounting Height*	FC at Center	Diameter of Beam**	FC at Beam**
5.5'	293	2.0'	142
6.5'	210	2.4'	101
7.5'	157	2.8'	76
8.5'	123	3.2'	59
10.0'	89	3.7'	43
12.0'	62	4.4'	30
14.0'	45	5.2'	22
16.0'	35	5.9'	17

SINGLE UNIT: PERFORMANCE INITIAL FOOTCANDLES AND BEAM ANGLE DIAMETERS			
Mounting Distance*	FC at Center	Diameter of Beam**	FC at Beam**
4.0'	554	1.4'	268
5.0'	354	1.8'	172
6.0'	246	2.1'	119
8.0'	138	2.8'	67
10.0'	89	3.5'	43
12.0'	62	4.2'	30
14.0'	45	4.9'	22
16.0'	35	5.6'	17

Delivered Lumens: 3386
Luminaire Watts: 43.4
LER: 78

CP @ 0° (Nadir): 8857
Direct Beam Angle: 21°
Indirect Beam Angle: 20°
CRI: 83

Spacing Ratio: N/A
Output Multipliers: 10L x 0.48, 13L x 0.65
83-0032

6" SQUARE DIRECT / INDIRECT

FOCUSED ILLUMINATION / PHOTOMETRIC DATA



C06xxSQUDXT-20LMDGL-20LMD-xxKEX-TCY-SOMW

20Lx2 MEDIUM - 83 CRI

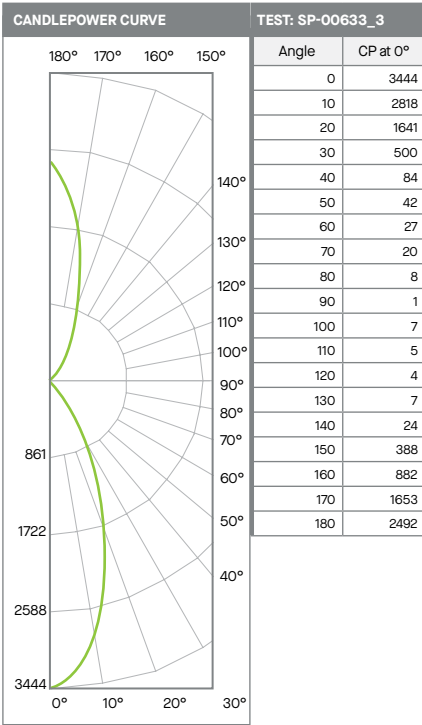

ZONAL LUMENS		
0-20	916	32%
0-40	1615	57%
0-60	1695	59%
0-90	1740	61%
90-120	16	1%
90-150	143	5%
90-180	1108	39%
Total Lumens	2849	100%

SINGLE UNIT: PERFORMANCE INITIAL FOOTCANDLES AND BEAM ANGLE DIAMETERS			
Mounting Height*	FC at Center	Diameter of Beam**	FC at Beam**
5.5'	114	3.9'	51
6.5'	82	4.6'	36
7.5'	61	5.3'	27
8.5'	48	6.0'	21
10.0'	34	7.0'	15
12.0'	24	8.4'	11
14.0'	18	9.8'	8
16.0'	13	11.2'	6

SINGLE UNIT: PERFORMANCE INITIAL FOOTCANDLES AND BEAM ANGLE DIAMETERS			
Mounting Distance*	FC at Center	Diameter of Beam**	FC at Beam**
4.0'	215	2.1'	100
5.0'	138	2.7'	64
6.0'	96	3.2'	45
8.0'	54	4.3'	25
10.0'	34	5.4'	16
12.0'	24	6.4'	11
14.0'	18	7.5'	8
16.0'	13	8.6'	6

Delivered Lumens: 2849 CP @ 0° (Nadir): 3444 Spacing Ratio: N/A
 Luminaire Watts: 43.4 Direct Beam Angle: 38.6° Output Multipliers: 10L x 0.48, 13L x 0.65
 LER: 66 Indirect Beam Angle: 30°
 CRI: 83

C06xxSQUDXT-20LWDGL-20LWD-xxKEX-TCY-SOMW

20Lx2 WIDE - 83 CRI

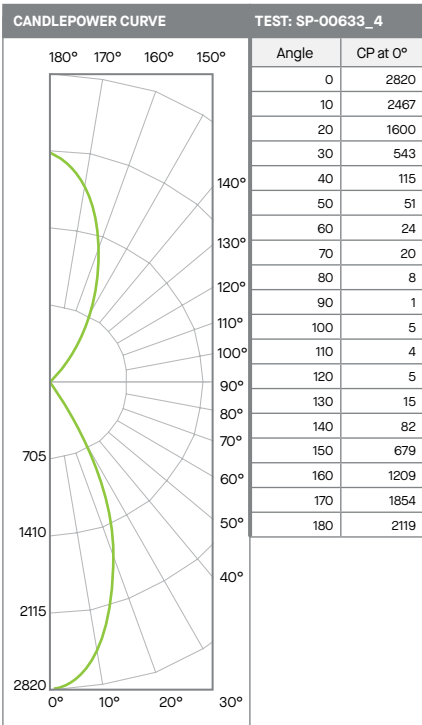

ZONAL LUMENS		
0-20	822	28%
0-40	1562	53%
0-60	1659	56%
0-90	1703	58%
90-120	15	1%
90-150	223	8%
90-180	1256	42%
Total Lumens	2959	100%

SINGLE UNIT: PERFORMANCE INITIAL FOOTCANDLES AND BEAM ANGLE DIAMETERS			
Mounting Height*	FC at Center	Diameter of Beam**	FC at Beam**
5.5'	93	4.4'	40
6.5'	67	5.2'	29
7.5'	50	6.0'	22
8.5'	39	6.8'	17
10.0'	28	8.0'	12
12.0'	20	9.6'	8
14.0'	14	11.3'	6
16.0'	11	12.9'	5

SINGLE UNIT: PERFORMANCE INITIAL FOOTCANDLES AND BEAM ANGLE DIAMETERS			
Mounting Distance*	FC at Center	Diameter of Beam**	FC at Beam**
4.0'	176	2.9'	78
5.0'	113	3.6'	50
6.0'	78	4.4'	35
8.0'	44	5.8'	19
10.0'	28	7.3'	12
12.0'	20	8.7'	9
14.0'	14	10.2'	6
16.0'	11	11.6'	5

Delivered Lumens: 2959 CP @ 0° (Nadir): 2820 Spacing Ratio: N/A
 Luminaire Watts: 43.4 Direct Beam Angle: 43.8° Output Multipliers: 10L x 0.48, 13L x 0.65
 LER: 68 Indirect Beam Angle: 40.0°
 CRI: 83

6" SQUARE DIRECT / INDIRECT

FOCUSED ILLUMINATION / PHOTOMETRIC DATA



C06xxSQUDXT-20LXWGL-20LXW-xxKEX-TCY-SOMW

20Lx2 XTRA WIDE - 83 CRI

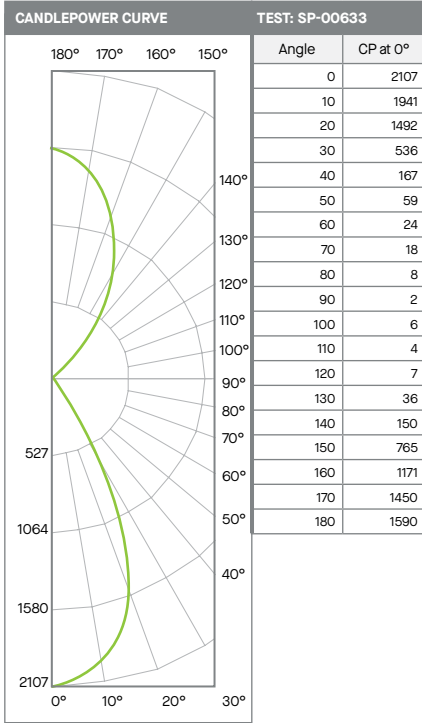

Beam Angle	Lumens	%
0-20	674	24%
0-40	1413	50%
0-60	1534	54%
0-90	1576	56%
90-120	15	1%
90-150	294	10%
90-180	1261	44%
Total Lumens	2837	100%

Mounting Height*	FC at Center	Diameter of Beam**	FC at Beam**
5.5'	70	5.2'	29
6.5'	50	6.1'	20
7.5'	37	7.1'	15
8.5'	29	8.0'	12
10.0'	21	9.4'	9
12.0'	15	11.3'	6
14.0'	11	13.2'	4
16.0'	8	15.1'	3

* From aperture to horizontal surface below.
** At IESNA defined Beam Angle, to 50% Max. CP.

Mounting Distance*	FC at Center	Diameter of Beam**	FC at Beam**
4.0'	132	3.7'	54
5.0'	84	4.7'	35
6.0'	59	5.6'	24
8.0'	33	7.5'	14
10.0'	21	9.3'	9
12.0'	15	11.2'	6
14.0'	11	13.1'	4
16.0'	8	14.9'	3

* From top of fixture to horizontal surface above.
** At IESNA defined Beam Angle, to 50% Max. CP.

Delivered Lumens: 2837
Luminaire Watts: 43.4
LER: 65

CP @ 0° (Nadir): 2107
Direct Beam Angle: 50.4°
Indirect Beam Angle: 50.0°
CRI: 83

Spacing Ratio: N/A
Output Multipliers: 10L x 0.48, 13L x 0.65