



# 12" ROUND DIRECT GENERAL ILLUMINATION



## C1210GV - CEILING MOUNT

### APPLICATION

12" round x 10" high cylinder series for general illumination with optional integral emergency battery.

### FEATURES

Spectrum's Cylinder series provides traditional architectural style with high performance and energy efficient illumination. Rugged design with flexible mounting, finish and LED options make these extremely versatile fixtures. Single stage optical system design delivers smooth general illumination.

### FINISH

Multi-stage polyester powder-coat process applied on our dedicated paint lines. See mounting and color pages for standard finishes. All exposed materials are chromate pre-treated to resist corrosion.

### ELECTRONICS

GV LED system features high brightness white Samsung LED's. 3-step MacAdam Ellipse binning. Standard CRI: 85+. Higher CRI, R9 and custom LED configurations are available; consult factory. Variety of electronic 120V/277V and dimming drivers. DMX controls available.

### CONSTRUCTION

Spun seamless aluminum fixture housing. Specular primary optical reflectors provide high efficiency illumination. Stainless steel hardware with galvanized steel brackets to resist corrosion. One piece reflector trim spun from .063 thick high purity aluminum and finished to specification.

### CODE COMPLIANCE

BAA compliant. ETL certified to meet US and Canadian standards. Suitable for dry or damp locations. Wet Location Option. Manufactured and tested to UL standards No. 1598/8750.

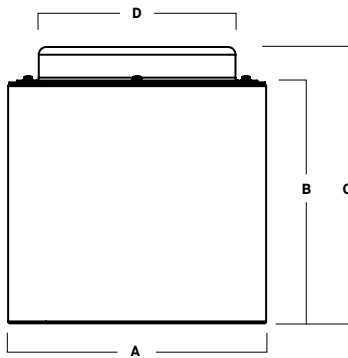

A	B	C	D
11.4 289.6 mm	10.3 261.6 mm	11.9 302.3 mm	8.7 221.0 mm

LUMENS / WATTAGE DATA				
PART NUMBER	SOURCE LUMENS <sup>1</sup>	DELIVERED LUMENS <sup>2</sup>	SYSTEM WATTS	LPW
C1210GV15L	1500	805	10	81
C1210GV27L	2700	1406	18	78
C1210GV37L	3700	2063	26	79
C1210GV55L	5500	3038	39	78

SERIES	LUMENS <sup>1</sup>	CCT	DRIVER / DIMMING <sup>3</sup>	OPTIONS <sup>7</sup>	TRIM	MOUNTING <sup>10</sup>	FINISH <sup>15</sup>
<b>C1210GV</b>	<b>15L</b> 1500 Lm	<b>27K</b> 2700K	<b>EX</b> Electronic Driver, 120V/277V	<b>FS</b> Fuse Holder and Fuse <b>WL</b> Wet Location	<b>TSG</b> <sup>9</sup> Semi Diffuse Low Iridescent Clear <b>TCY</b> Same Color as Cylinder <b>TCC</b> Custom Color	<b>HM</b> <sup>11/12</sup> Hang Straight <b>PM</b> <sup>11/12</sup> Rigid Pendant Mount <b>AT</b> <sup>11/12</sup> Hang Straight All Thread <b>CD3X</b> <sup>8/11/13</sup> 3X Cord / Cable Mount <b>SM</b> Surface Mount <b>CQD</b> <sup>6</sup> DMX Large Driver Canopy	<b>MW</b> <sup>16</sup> Matte White <b>MB</b> <sup>16</sup> Matte Black <b>PT</b> <sup>16</sup> Platinum Silver <b>CC</b> Custom Color
	<b>27L</b> 2700 Lm	<b>30K</b> 3000K	<b>DS10X</b> 10%, 0-10V, 120V/277V				
	<b>37L</b> 3700 Lm	<b>35K</b> 3500K	<b>DO10X</b> 1%, 0-10V, 120V/277V				
	<b>55L</b> 5500 Lm	<b>40K</b> 4000K	<b>DS2W1</b> ELV / MLV, 120V				
		<b>50K</b> 5000K	<b>DLTE1</b> <sup>4</sup> Lutron 2-Wire Forward Phase (MLV), 120V <b>DL3E1</b> <sup>4</sup> 1% Lutron® EcoSystem® Fade, 120V/277V <b>EDO1X</b> 0.1%, eldoLED 120V/277V <b>DALIX</b> DALI Control <b>DMXS</b> <sup>5/6</sup> DMX Standard Configuration <b>DMXC</b> <sup>5/6</sup> DMX Non-Standard Custom		<b>LENS</b> <b>SO</b> Micro Prism Solite™ Lens <b>GL</b> Clear Glass Lens <b>FG</b> Frosted Glass Lens	<b>EMERGENCY BATTERY OPTIONS</b> <b>EMIT</b> <sup>14</sup> 7W Emergency Battery Test Switch <b>EMRM</b> 7W Remote EM	

**EXAMPLE:** C1210GV55L35KEX/TSG/SM/MW

**NOTES:**  
<sup>1</sup> Nominal Source Lumens at 35K    <sup>2</sup> Nominal Delivered Lumens at 35K with TSG-SO-MW    <sup>3</sup> Contact Factory for Additional Options    <sup>4</sup> 37L Max    <sup>5</sup> Contact Factory    <sup>6</sup> CQD Required for DMXS/C  
<sup>7</sup> See Product Options Page For Details    <sup>8</sup> Wet Location Unavailable with CD    <sup>9</sup> Standard Finish    <sup>10</sup> See Mounting Page for Details on Components and Finishes    <sup>11</sup> Specify Length in Inches: See Mounting Page for Available Lengths  
<sup>12</sup> Not for Use in Locations with Wind Exposure    <sup>13</sup> EMxxxx Option Requires 2 Cords/Not Available for WL    <sup>14</sup> EMIT Up to 37L    <sup>15</sup> Reference Color Sheet Located on Product Webpage for Full List of Available Colors    <sup>16</sup> Standard Finishes



PROJECT: \_\_\_\_\_  
 TYPE: \_\_\_\_\_



Dimensions and values shown are nominal. Spectrum Lighting continually works to improve products and reserves the right to make changes which may alter the performance or appearance of products.

# 12" ROUND DIRECT

GENERAL ILLUMINATION / FIXTURE OPTIONS



## STANDARD FINISHES

**MW**  
MATTE WHITE



**MB**  
MATTE BLACK



**PT**  
PLATINUM SILVER



## MOUNTING TYPES

**HM / PM / AT**

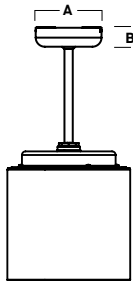

A	B
5.0	1.5
127.0 mm	38.1 mm

**CD3X**  
3X CORD / CABLE MOUNT

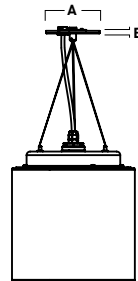

A	B
5.0	.25
127.0 mm	6.4 mm

\*Not Available for Wet Location

**SM**  
SURFACE MOUNT

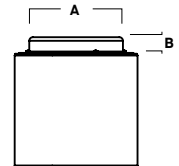

A	B
6.2	1.5
157.5 mm	25.4 mm

# STANDARD MOUNTING & ACCESSORIES

SOME OPTIONS NOT AVAILABLE ON ALL FIXTURES, CONSULT SPECIFICATION SHEETS. SEE INDIVIDUAL SPECIFICATION SHEETS OR CONSULT FACTORY FOR ADDITIONAL INFORMATION. NOTE: THIS IS TYPICAL OF CYLINDERS SPECIFICATION FOR PENDANT MOUNTING. INDIVIDUAL FIXTURES OR PROJECTS MAY HAVE SPECIALIZED REQUIREMENTS.



## MOUNTING TYPES

<p><b>HM*</b> HANG STRAIGHT 45° SWIVEL 5/8" OD STEM - 3/8" IP</p> <p>ORDER: <b>HM</b> (Length) SPECIFY LENGTH: <b>HM3</b> - 3"    <b>HM24</b> - 24" <b>HM6</b> - 6"    <b>HM36</b> - 36" <b>HM12</b> - 12"    <b>HM48</b> - 48" <b>HM18</b> - 18"    <b>HM72</b> - 72" <b>HMLC(XX)</b> Custom Length (Specify in Inches)</p>	<p><b>PM*</b> RIGID PENDANT MOUNT RIGID 5/8" OD STEM - 3/8" IP</p> <p>ORDER: <b>PM</b> (Length) SPECIFY LENGTH: <b>PM3</b> - 3"    <b>PM24</b> - 24" <b>PM6</b> - 6"    <b>PM36</b> - 36" <b>PM12</b> - 12"    <b>PM48</b> - 48" <b>PM18</b> - 18"    <b>PM72</b> - 72" <b>PMLC(XX)</b> Custom Length (Specify in Inches)</p>	<p><b>AT**</b> HANG STRAIGHT ALL THREAD 45° SWIVEL 5/8" OD STEM - 1/4" IP</p> <p>ORDER: <b>AT</b> (Length) SPECIFY LENGTH: <b>AT12</b> - 12" <b>AT24</b> - 24" <b>AT36</b> - 36"</p>	<p><b>CD3X</b> CORD / CABLE MOUNT SJ CORD WITH 1/16 SS CABLE</p> <p>ORDER: <b>CDX3</b> (Length) SPECIFY LENGTH: <b>CD3x36</b> - 36" <b>CD3x72</b> - 72" <b>CD3x144</b> - 144" <b>CDLC3X(XX)</b> Custom Length (Specify in Inches)</p>	<p><b>SM</b> SURFACE MOUNT WIRING COMPARTMENT / TOP HAT</p> <p>ORDER: <b>SM</b> TOP VIEW CANOPY 3.5</p> <p>KEY SLOTS MOUNT CANOPY TO WALL JUNCTION BOX. JUNCTION BOX IS COVERED.</p>
--	---	--	---	--

\*MAXIMUM ONE PIECE STEM LENGTH IS 72". \*\*MAXIMUM ONE PIECE STEM LENGTH IS 36". LONGER LENGTHS ARE POSSIBLE USING MULTIPLE STEMS AND COUPLERS.

## DMX OPTION

**CQD** - LARGE DRIVER CANOPY FOR DMX OPTIONS

## REMOTE EMERGENCY BATTERY OPTIONS

**EMRM\*** - 7W REMOTE EMERGENCY BATTERY (50' MAX)

A	B	C
1.3	12.6	13.0

\*OTHER EM BATTERY SIZES AVAILABLE, CONSULT FACTORY

# 12" ROUND DIRECT

## GENERAL ILLUMINATION / PHOTOMETRIC DATA



C1210GV-55L35K-EXxx-TSG-SO-xxMW

55L - 85 CRI

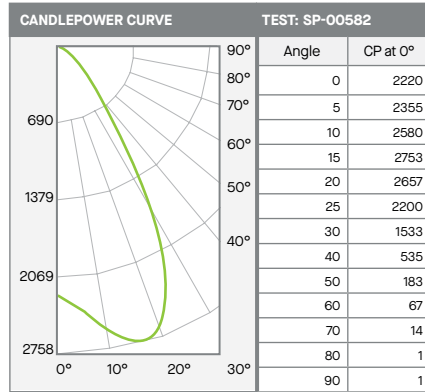

Beam Angle	Zonal Lumens	% of Total
0-10	230	8%
0-20	987	32%
0-30	1986	65%
0-40	2622	86%
0-60	2993	99%
0-80	3036	100%
0-90	3038	100%
Total Lumens	3038	100%

Mounting Height*	FC at Center	Diameter of Beam**	FC at Beam**
5.5'	73	6.7'	27
6.5'	53	7.9'	19
7.5'	39	9.1'	14
8.5'	31	10.4'	11
10.0'	22	12.2'	8
12.0'	15	14.6'	6
14.0'	11	17.1'	4
16.0'	9	19.5'	3

\* From aperture to horizontal surface below.  
 \*\* At IESNA defined Beam Angle, to 50% Max. CP.

Delivered Lumens: 3038    CP @ 0° (Nadir): 2220    Spacing Ratio: 1.12  
 Luminaire Watts: 39    Beam Angle: 62.7°    Output Multipliers: 15L x 0.27, 27L x 0.46, 37L x 0.68  
 LER: 78    CRI: 84