



8" ROUND DIRECT FOCUSED ILLUMINATION



C0812XT, C0816XT, C0824XT - WALL MOUNT

APPLICATION

8" round x 12", 16" or 24" high 8" diameter cylinder luminaire for accent and general illumination.

FEATURES

Spectrum's Cylinder series provides traditional architectural style with high performance and energy efficient illumination. Rugged design with flexible mounting, finish and LED options make these extremely versatile fixtures. Quick change LED module with interchangeable optics for fixture upgrade.

FINISH

Multi-stage polyester powder-coat process applied on our dedicated paint lines. See mounting and color pages for standard finishes. All exposed materials are chromate pretreated to resist corrosion.

ELECTRONICS

LED system features Xicato LED module with proprietary phosphor technology that provides consistent stable color with CCT control of +/- 100K over life of the light engine. Base CRI is 83 with 2-step MacAdam Ellipse binning. High CRI is 98 with 1 x 2-step MacAdam Ellipse binning. Variety of electronic 120V/277V and dimming drivers.

CONSTRUCTION

Fabricated seamless aluminum fixture housing. Silicone gasket seals optical chamber. Specular primary optical reflectors provide high efficiency illumination. Impact resistant tempered glass lenses. Stainless steel hardware with galvanized steel brackets to resist corrosion. Trim formed from .063 thick high purity aluminum and finished to specification.

CODE COMPLIANCE

BAA compliant. ETL certified to meet US and Canadian standards. Suitable for dry or damp locations. Wet Location Option. Manufactured and tested to UL standards No. 1598/8750.

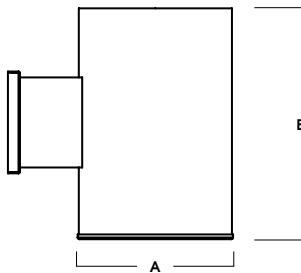

SERIES	A	B
C0812XT	8.0	12.1
C0816XT	8.0	16.1
C0824XT	8.0	24.1

Fixture Weight: 23.5 lbs

LUMENS / WATTAGE DATA				
PART NUMBER	SOURCE LUMENS	DELIVERED LUMENS ²	SYSTEM WATTS ³	LPW
C0812XT10L	1000	760	9.1	84
C0812XT13L	1300	1024	13.0	79
C0812XT20L	2000	1575	21.7	73

SERIES	LUMENS ¹	CCT	OPTICS	DRIVER / DIMMING ⁶	OPTIONS ⁷	TRIM	MOUNTING ⁹	FINISH ¹⁰
C0812XT ⁵ 8" x 12" Cylinder	10L 1000 Lm	83 CRI	XN 12° ND 22° MD 39° WD 46° XW 57°	EX Electronic Driver, 120V/277V DS10X 10%, 0-10V, 120V/277V DO10X 1%, 0-10V, 120V/277V DS2W1 ELV/MLV, 120V	WL Wet Location FS Fuse Holder and Fuse CR Corrosion Resistant	TSG Semi-Diffuse Low Iridescent Clear TCY Same Color as Cylinder TCC Custom Color	WM3 Wall Mount 3" Extension WM5 Wall Mount 5" Extension	MW ¹¹ Matte White MB ¹¹ Matte Black PT ¹¹ Platinum Silver CC Custom Color
	13L 1300 Lm	27K 2700K 30K 3000K 35K 3500K 40K 4000K						
	20L 2000 Lm							
C0816XT ⁵ 8" x 16" Cylinder		98 CRI						See Page 5 for Full Range of Color Options (83-90095)
		27HK 2700K 30HK 3000K 35HK 3500K 40HK 4000K						
C0824XT ⁵ 8" x 24" Cylinder						LENS NL ⁸ No Lens GL Clear Glass Lens FG Frosted Glass Lens SO Micro Prism Solite™ Lens	EMERGENCY BATTERY OPTIONS EMRM 7W Remote EM EMEN 7W Remote with Enclosure	

EXAMPLE: C0812XT20L35KNDEX/TSGGL/WM3/MW

NOTES:
 1 Nominal Source Lumens at Any CCT 2 Nominal Delivered Lumens at 83 CRI at Any CCT with MD-TSG-SO 3 At 83 CRI 4 98 CRI 13L Max, XN 80 CRI 13L Max, XN 98 CRI 10L Max 5 XN 80 CRI 13L Max, XN 98 CRI 10L Max
 6 Contact Factory for Additional Options 7 See Product Options Page for Details 8 Not Available with WL 9 See Mounting Page for Details on Components and Finishes 10 See Color Page for More Options/Consult Factory for Special Finishes 11 Standard Finishes



PROJECT: _____
 TYPE: _____



Dimensions and values shown are nominal. Spectrum Lighting continually works to improve products and reserves the right to make changes which may alter the performance or appearance of products.

8" ROUND DIRECT

FOCUSED ILLUMINATION / FIXTURE OPTIONS



SERIES SIZES

C0812XT

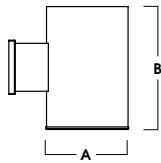

A	B
8.0	12.1
203.2 mm	307.3 mm

C0816XT

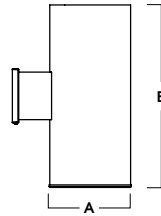

A	B
8.0	16.1
203.2 mm	408.9 mm

C0824XT

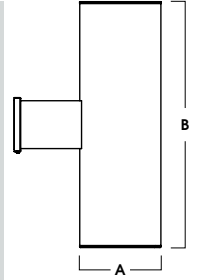

A	B
8.0	24.1
203.2 mm	612.1 mm

STANDARD FINISHES

MW
MATTE WHITE



MB
MATTE BLACK



PT
PLATINUM SILVER



WALL MOUNT DETAIL

WM3
WALL MOUNT 3" EXTENSION



FRONT VIEW

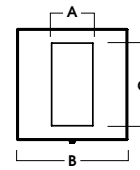

SIDE VIEW

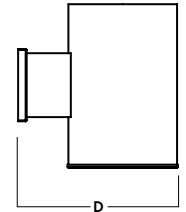

A	B	C	D
2.4	6.4	4.7	11.7
61.0 mm	162.6 mm	119.4 mm	297.2 mm

WM5
WALL MOUNT 5" EXTENSION

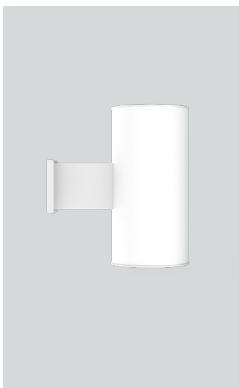

FRONT VIEW

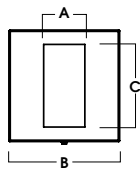

SIDE VIEW

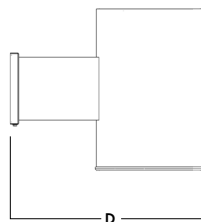

A	B	C	D
2.4	6.4	4.7	14.5
61.0 mm	162.6 mm	119.4 mm	368.3 mm

EMERGENCY BATTERY OPTIONS

EMRM* - 7W REMOTE EMERGENCY BATTERY
(50' MAX)

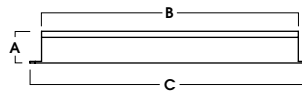

A	B	C
1.3	12.6	13.0

EMEN* - 7W REMOTE EMERGENCY BATTERY
WITH ENCLOSURE (50' MAX)

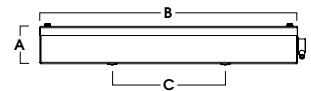

A	B	C
2.0	17.0	6.2

*OTHER EM BATTERY SIZES AVAILABLE. CONSULT FACTORY

8" ROUND DIRECT

FOCUSED ILLUMINATION / PHOTOMETRIC DATA



C08xxXT-30LxxK-NDEX-SGNL

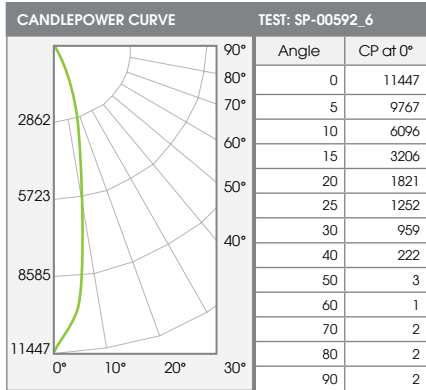

Distance	Lumens	%
0-10	844	29%
0-20	1870	64%
0-30	2491	85%
0-40	2880	98%
0-60	2935	100%
0-80	2938	100%
0-90	2939	100%
Total Lumens	2939	100%

30L NARROW - 83 CRI

Mounting Height*	FC at Center	Diameter of Beam**	FC at Beam**
5.5'	378	2.1'	183
6.5'	271	2.5'	131
7.5'	204	2.8'	98
8.5'	158	3.2'	76
10.0'	114	3.8'	55
12.0'	79	4.5'	38
14.0'	58	5.3'	28
16.0'	45	6.0'	22

* From aperture to horizontal surface below.
** At IESNA defined Beam Angle, to 50% Max. CP.

Delivered Lumens: 2939 CP @ 0° (Nadir): 11447 Spacing Ratio: 0.36
 Luminaire Watts: 32.6 Beam Angle: 21.4° Output Multipliers: 10L x 0.32, 13L x 0.43, 20L x 0.67, 30L x 1.0
 LER: 90 CRI: 83

C08xxXT-30LxxK-MDEX-SGNL

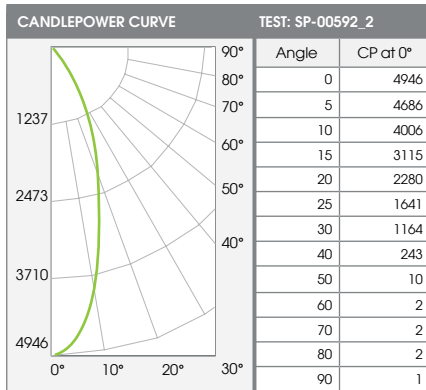

Distance	Lumens	%
0-10	427	17%
0-20	1299	50%
0-30	2072	80%
0-40	2504	97%
0-60	2576	100%
0-80	2579	100%
0-90	2581	100%
Total Lumens	2581	100%

30L MEDIUM - 83 CRI

Mounting Height*	FC at Center	Diameter of Beam**	FC at Beam**
5.5'	164	3.8'	73
6.5'	117	4.4'	52
7.5'	88	5.1'	39
8.5'	68	5.8'	31
10.0'	49	6.8'	22
12.0'	34	8.2'	15
14.0'	25	9.6'	11
16.0'	19	10.9'	9

* From aperture to horizontal surface below.
** At IESNA defined Beam Angle, to 50% Max. CP.

Delivered Lumens: 2581 CP @ 0° (Nadir): 4946 Spacing Ratio: 0.62
 Luminaire Watts: 32.6 Beam Angle: 37.7° Output Multipliers: 10L x 0.32, 13L x 0.43, 20L x 0.67, 30L x 1.0
 LER: 79 CRI: 83

C08xxXT-30LxxK-WDEX-SGNL

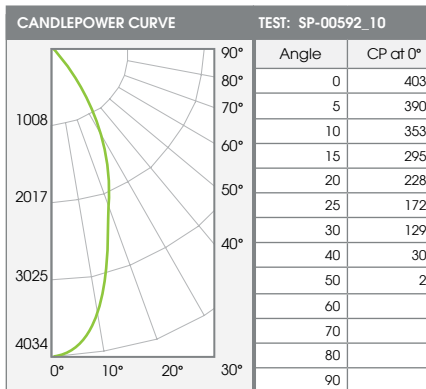

Distance	Lumens	%
0-10	361	14%
0-20	1179	46%
0-30	1980	77%
0-40	2474	96%
0-60	2572	100%
0-80	2575	100%
0-90	2577	100%
Total Lumens	2577	100%

30L WIDE - 83 CRI

Mounting Height*	FC at Center	Diameter of Beam**	FC at Beam**
5.5'	133	4.5'	57
6.5'	95	5.4'	41
7.5'	72	6.2'	31
8.5'	56	7.0'	24
10.0'	40	8.2'	17
12.0'	28	9.9'	12
14.0'	21	11.5'	9
16.0'	16	13.2'	7

* From aperture to horizontal surface below.
** At IESNA defined Beam Angle, to 50% Max. CP.

Delivered Lumens: 2577 CP @ 0° (Nadir): 4034 Spacing Ratio: 0.7
 Luminaire Watts: 32.6 Beam Angle: 44.8° Output Multipliers: 10L x 0.32, 13L x 0.43, 20L x 0.67, 30L x 1.0
 LER: 79 CRI: 83

8" ROUND DIRECT

FOCUSED ILLUMINATION / PHOTOMETRIC DATA



C08xxXT-30LxxK-XWEX-SGNL

30L XTRA WIDE - 83 CRI

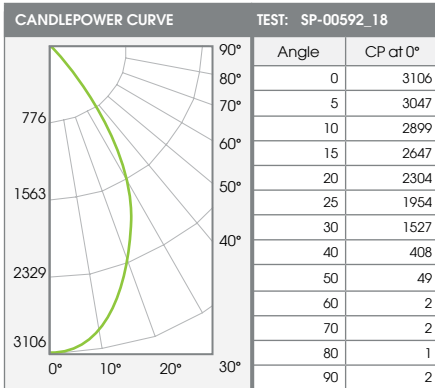

ZONAL LUMENS

0-10	286	11%
0-20	1021	38%
0-30	1915	71%
0-40	2525	94%
0-60	2679	100%
0-80	2683	100%
0-90	2685	100%
Total Lumens	2685	100%

SINGLE UNIT: PERFORMANCE
INITIAL FOOTCANDLES AND BEAM ANGLE DIAMETERS

Mounting Height*	FC at Center	Diameter of Beam**	FC at Beam**
5.5'	103	6.2'	39
6.5'	74	7.4'	28
7.5'	55	8.5'	21
8.5'	43	9.6'	16
10.0'	31	11.3'	12
12.0'	22	13.6'	8
14.0'	16	15.9'	6
16.0'	12	18.1'	5

* From aperture to horizontal surface below.
** At IESNA defined Beam Angle, to 50% Max. CP.

Delivered Lumens: 2685
Luminaire Watts: 32.6
LER: 82

CP @ 0° (Nadir): 3106
Beam Angle: 59.1°
CRI: 83

Spacing Ratio: 0.9
Output Multipliers: 10L x 0.32, 13L x 0.43, 20L x 0.67, 30L x 1.0

COLOR OPTIONS - POWDER COAT PAINT FINISHES

NOTE: NO PRINTED IMAGE CAN EQUAL THE EXACT COLOR OF FINISH ON METAL.
SEE INDIVIDUAL SPECIFICATION SHEETS OR CONSULT FACTORY FOR ADDITIONAL INFORMATION.



STANDARD CORD / STEM / CANOPY FINISHES

FIXTURE COLOR	STANDARD CORD COLOR	STANDARD CANOPY / STEM COLOR
Matte White, Textured White	Matte White	Matte White
Gloss White	Matte White	Gloss White
Matte Black, Textured Black	Matte Black	Matte Black
All Others	Matte Black	Same Color as Fixture
Custom Color	Contact Factory	Contact Factory

PAINT TIMES

TIER	COST	AVERAGE PAINT TIME*
Tier 1 - Standard Finishes	\$	⌚
Tier 2 - Typical Finishes	\$\$	⌚⌚
Custom Color	Contact Factory	Contact Factory

*CONTACT FACTORY FOR SPECIFIC PRODUCT LEAD TIMES

TIER 1 - STANDARD FINISHES

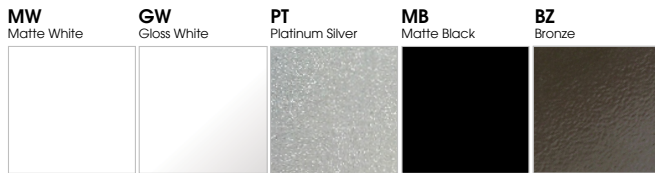

TIER 2 - TYPICAL FINISHES

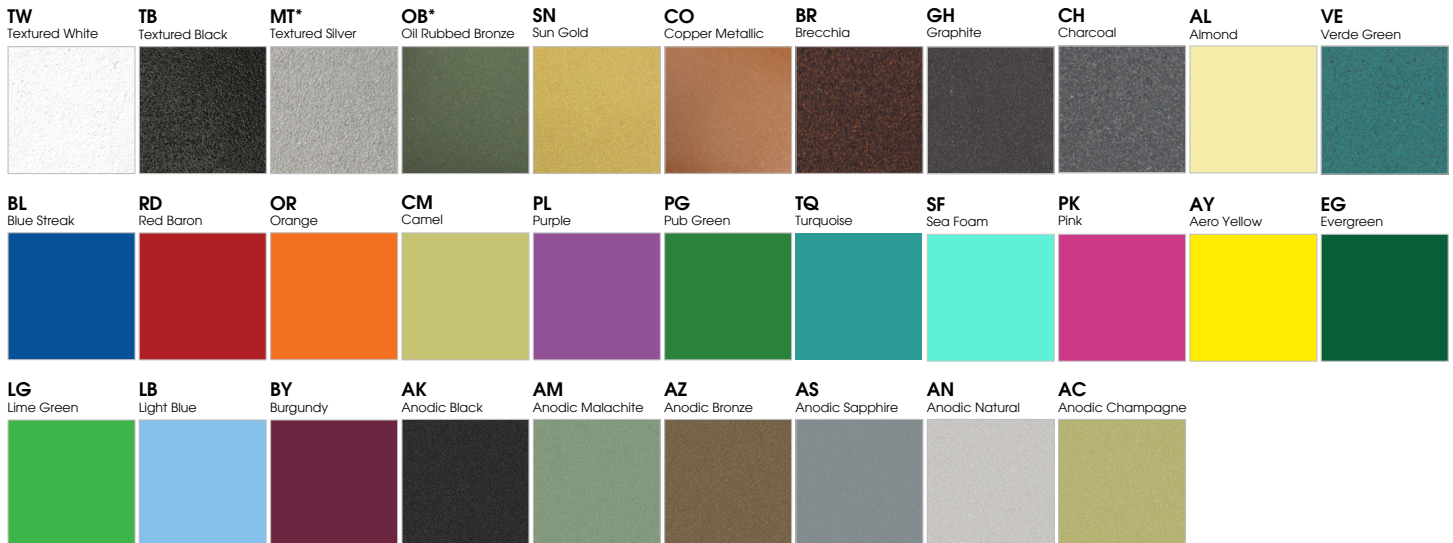

CUSTOM COLOR FINISHES

CONTACT FACTORY

CC
Custom Color



*UNAVAILABLE FOR WET LOCATION