



COMMERCIAL DOWNLIGHT SERIES BY SPECTRUM

4" SQUARE DOWNLIGHT

NON-IC CONSTRUCTION

Spectrum's Infinium 4" recessed square downlight series features a shallow plenum housing for general illumination.

LUMENS AND WATTAGE CHART			
PART NUMBER	DELIVERED LUMENS ¹	SYSTEM WATTS	LPW
SGE4SQFX10L	687	6.6	104
FX15L	1067	10.5	102
SGE4SQFX20L	1448	14.4	101
SGE4SQFX30L	2172	21.9	99
SGE4SQFX40L	2933	30	98
SGE4SQFX50L	3732	38.3	97

¹ Nominal Delivered Lumens at 35K with MW SO

PROJECT: _____
 QUANTITY: _____ TYPE: _____



MATTE WHITE
MATCHING FLANGE

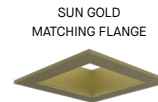
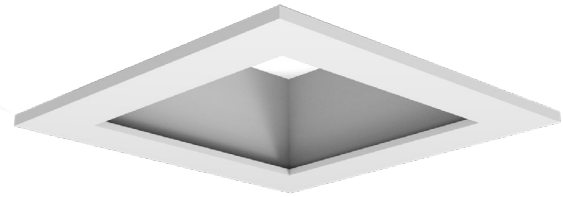

AVAILABLE HOUSING TYPE

SGE4SQFX - Downlight

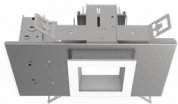

SGW4SQFX - Wall Wash

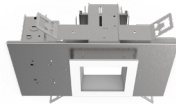

PRODUCT SELECTOR GUIDE

SERIES	LUMENS	CRI / CCT	DRIVER / VOLTAGE	EMERGENCY	BAR HANGERS	TRIM TYPE	FINISH	FLANGE FINISH	LENS	TRIM OPTIONS
SGE4SQFX						CAO244FX				
SGE4SQFX	15L	35K	DX		BH27	CAO244FX	MW	MF	SO	

EXAMPLE

FIXTURE HOUSING SPECIFICATION

SERIES	LUMENS	CRI / CCT	DRIVER / VOLTAGE	EMERGENCY	BAR HANGERS
Downlight SGE4SQFX	10L 700 Lm 15L 1050 Lm 20L 1450 Lm 30L 2200 Lm 40L 2950 Lm 50L 3750 Lm	90 Minimum 27HK 2700K 30HK 3000K 35HK 3500K 40HK 4000K	DX 1%, 0-10V, 120V/277V DS2W1 1%, ELV/TRIAC, 120V	EMIT 7W Emergency Battery Test Switch in Trim Requires EMIT Trim. Not Available with Wall Wash EM Integral Emergency Battery EMRM Remote Emergency Battery Pack Installer Responsible For EM Access	BH27 27" Solid Bars Standard Bar Hangers H12 12" - 24" Expandable Bars CB24 24" C-Channel Bars
Wall Wash SGW4SQFX	Nominal Delivered Lumens at 35K with MW SO	80 Minimum 30K 3000K 35K 3500K 40K 4000K 50K 5000K			

- Up to 3700 delivered lumens.
- Smooth light distribution for general illumination.
- Shallow plenum construction.
- Quick Ship options available.
- L70 at >60,000 Hours at 70% lumens maintenance.
- 5 year warranty on fixture and electronics.
- Sustainable fixture.
- Damp or wet location listed.
- Ease of maintenance.
- Posi-lock trim retention torsion springs.

TRIM SPECIFICATION

TRIM TYPE	FINISH	FLANGE FINISH	LENS	TRIM OPTIONS
Downlight CAO244FX	MW Matte White MB Matte Black PT Platinum Silver CC Custom Color Consult Factory	MF Matching Flange NON MATCHING WF White Flange BF Black Flange SF Platinum Flange CCF Custom Color Flange Consult Factory	STANDARD LENS FOR DOWNLIGHT SO Micro Prism Solite™ Lens	W Wet Location Gasket is Supplied with "W" Option GS Gasket
Wall Wash CAO294FX	See Color Guide for Full Range of Color Options	See Color Guide for Full Range of Color Options	STANDARD LENS FOR WALL WASH SK Skytex™ Lens	

GREEN TEXT INDICATES QUICK SHIP OPTIONS



HOUSING DIMENSIONS

SGE4SQFX - NEW CONSTRUCTION

Non-IC rated, thermally protected frame-in kit for new construction.

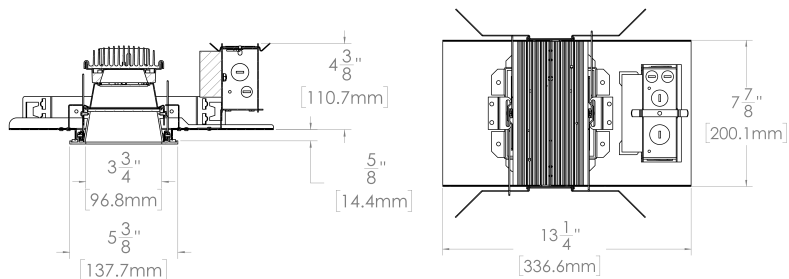

EMIT - EMERGENCY BATTERY TEST SWITCH IN TRIM

Non-IC rated, thermally protected frame-in kit for new construction.

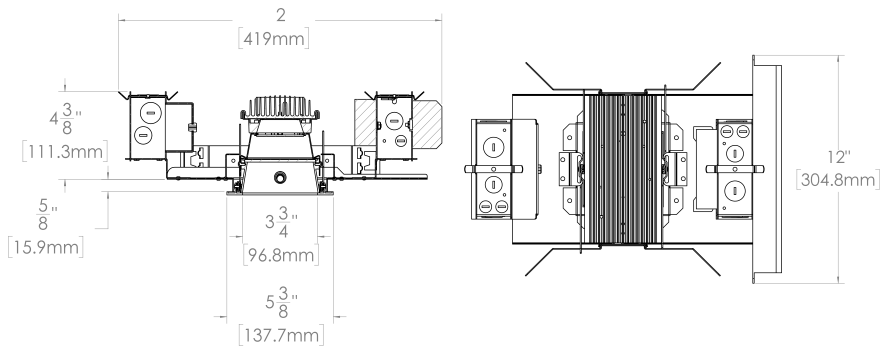

FEATURES

QUICK SHIP

Quick Ship highlights products that can ship in 3 - 5 working days.

APPLICATIONS

FX series 4" square downlights designed for general downlighting with smooth light distribution.

FEATURES

Shallow plenum construction. Auto dim thermal protector for long term reliability. Zhaga international standard LED module for ease of maintenance and future replacement. Tool-less LED module, driver, and J-Box access. Multi-Bar mounting brackets, fit a variety of mounting bars. Posi-lock trim retention torsion springs. Integral 5/8" (.625) collar, works in ceiling up to 1" Deep. Intended for Non-IC new construction.

FINISH

Variety of powdercoat finishes available. Matte white flange is standard.

ELECTRONICS

LED system features high efficacy Philips LEDs. Standard CRI is >80. Drivers are overload and short circuit protected as well as thermally regulated. Sound rating A.

CONSTRUCTION

Housing/frame constructed of #20 ga. galvanized steel to resist corrosion. Self-Flanged one piece trim die-cast high purity aluminum and finished to specification. Passive machined aluminum heatsink.

TRIM DATA

CA0244FX - DOWNLIGHT



CA0249FX - WALL WASH



PHOTOMETRIC DATA - 4" SQUARE DOWNLIGHT

SGE4SQLEDFX 50L 35K XX CA0244FX MW WF SO

CANDLEPOWER CURVE TEST SP-01220	INTENSITY CANDELA 0° AZIMUTH	ZONAL LUMENS	SINGLE UNIT: PERFORMANCE DIRECT FOOTCANDLES BASED ON DOWNLIGHT ONLY	MULTIPLE UNITS: PERFORMANCE 80/50/20% REFLECTANCES INITIAL FOOTCANDLES AND WATTS PER SQUARE FOOT																																								
	0°	2717	0° - 10° 262 7%	<table border="1"> <thead> <tr> <th rowspan="2">Ceiling Height</th> <th rowspan="2">Fixture Spacing</th> <th colspan="2">RCR 2</th> <th colspan="2">RCR 4</th> </tr> <tr> <th>FC *</th> <th>W/Sq. Ft.</th> <th>FC *</th> <th>W/Sq. Ft.</th> </tr> </thead> <tbody> <tr> <td>10'</td> <td>6'</td> <td>91</td> <td>0.98</td> <td>75</td> <td>0.98</td> </tr> <tr> <td>12'</td> <td>8'</td> <td>56</td> <td>0.61</td> <td>47</td> <td>0.61</td> </tr> <tr> <td>16'</td> <td>10'</td> <td>38</td> <td>0.41</td> <td>23</td> <td>0.30</td> </tr> <tr> <td colspan="2">Delivered Illuminance Rating: (DIR)</td> <td colspan="2">92 FC per W/Sq. Ft.</td> <td colspan="2">77 FC per W/Sq. Ft.</td> </tr> <tr> <td colspan="6"> Recessed mounting Square rooms used for multiple units: RCR 2: Length & Width = Ceiling Ht. - 2.5' x 5.00 RCR 4: Length & Width = Ceiling Ht. - 2.5' x 2.50 * Average Footcandles at 2.5' Above Floor </td> </tr> </tbody> </table>	Ceiling Height	Fixture Spacing	RCR 2		RCR 4		FC *	W/Sq. Ft.	FC *	W/Sq. Ft.	10'	6'	91	0.98	75	0.98	12'	8'	56	0.61	47	0.61	16'	10'	38	0.41	23	0.30	Delivered Illuminance Rating: (DIR)		92 FC per W/Sq. Ft.		77 FC per W/Sq. Ft.		Recessed mounting Square rooms used for multiple units: RCR 2: Length & Width = Ceiling Ht. - 2.5' x 5.00 RCR 4: Length & Width = Ceiling Ht. - 2.5' x 2.50 * Average Footcandles at 2.5' Above Floor					
	Ceiling Height	Fixture Spacing	RCR 2				RCR 4																																					
			FC *		W/Sq. Ft.	FC *	W/Sq. Ft.																																					
	10'	6'	91		0.98	75	0.98																																					
	12'	8'	56		0.61	47	0.61																																					
	16'	10'	38		0.41	23	0.30																																					
	Delivered Illuminance Rating: (DIR)		92 FC per W/Sq. Ft.		77 FC per W/Sq. Ft.																																							
	Recessed mounting Square rooms used for multiple units: RCR 2: Length & Width = Ceiling Ht. - 2.5' x 5.00 RCR 4: Length & Width = Ceiling Ht. - 2.5' x 2.50 * Average Footcandles at 2.5' Above Floor																																											
	0° - 20°	989	26%		Mounting Height AFF	FC at Center on Floor	Beam Diameter	FC at Beam Edge																																				
	5°	2711	0° - 30°		1901	51%	8'	42 fc	9.2'	14 fc																																		
15°	2545	0° - 40°	2590	69%	10'	27 fc	11.5'	9 fc																																				
25°	1783	0° - 60°	3346	90%	12'	19 fc	13.9'	6 fc																																				
35°	866	0° - 80°	3687	99%	14'	14 fc	16.2'	5 fc																																				
45°	486	0° - 90°	3721	100%	16'	11 fc	18.5'	4 fc																																				
55°	356	Total	3732	100%	20'	7 fc	23.1'	2 fc																																				
90°	5				24'	5 fc	27.7'	2 fc																																				
					28'	3 fc	32.3'	1 fc																																				

Delivered Lumens: 3732
Luminaire Watts: 38.4
LER: 97.19

CP at 0° (Nadir): 2717
CRI: 80+

Beam Angle: 61°
Spacing Ratio: 0.91

Lumen Multiplier: 10L x 0.18, 15L x 0.29, 20L x 0.39, 30L x 0.58, 40L x 0.78
CCT Multiplier: 27HK x 0.77, 30K x 0.96, 40K x 1.03, 50K x 1.04

SGE4SQLEDFX 50L 35K XX CA0244FX PT WF SO

CANDLEPOWER CURVE TEST SP-01220_1	INTENSITY CANDELA 0° AZIMUTH	ZONAL LUMENS	SINGLE UNIT: PERFORMANCE DIRECT FOOTCANDLES BASED ON DOWNLIGHT ONLY	MULTIPLE UNITS: PERFORMANCE 80/50/20% REFLECTANCES INITIAL FOOTCANDLES AND WATTS PER SQUARE FOOT																																								
	0°	2653	0° - 10° 257 8%	<table border="1"> <thead> <tr> <th rowspan="2">Ceiling Height</th> <th rowspan="2">Fixture Spacing</th> <th colspan="2">RCR 2</th> <th colspan="2">RCR 4</th> </tr> <tr> <th>FC *</th> <th>W/Sq. Ft.</th> <th>FC *</th> <th>W/Sq. Ft.</th> </tr> </thead> <tbody> <tr> <td>10'</td> <td>6'</td> <td>78</td> <td>0.98</td> <td>67</td> <td>0.98</td> </tr> <tr> <td>12'</td> <td>8'</td> <td>49</td> <td>0.61</td> <td>42</td> <td>0.61</td> </tr> <tr> <td>16'</td> <td>10'</td> <td>33</td> <td>0.41</td> <td>21</td> <td>0.30</td> </tr> <tr> <td colspan="2">Delivered Illuminance Rating: (DIR)</td> <td colspan="2">79 FC per W/Sq. Ft.</td> <td colspan="2">68 FC per W/Sq. Ft.</td> </tr> <tr> <td colspan="6"> Recessed mounting Square rooms used for multiple units: RCR 2: Length & Width = Ceiling Ht. - 2.5' x 5.00 RCR 4: Length & Width = Ceiling Ht. - 2.5' x 2.50 * Average Footcandles at 2.5' Above Floor </td> </tr> </tbody> </table>	Ceiling Height	Fixture Spacing	RCR 2		RCR 4		FC *	W/Sq. Ft.	FC *	W/Sq. Ft.	10'	6'	78	0.98	67	0.98	12'	8'	49	0.61	42	0.61	16'	10'	33	0.41	21	0.30	Delivered Illuminance Rating: (DIR)		79 FC per W/Sq. Ft.		68 FC per W/Sq. Ft.		Recessed mounting Square rooms used for multiple units: RCR 2: Length & Width = Ceiling Ht. - 2.5' x 5.00 RCR 4: Length & Width = Ceiling Ht. - 2.5' x 2.50 * Average Footcandles at 2.5' Above Floor					
	Ceiling Height	Fixture Spacing	RCR 2				RCR 4																																					
			FC *		W/Sq. Ft.	FC *	W/Sq. Ft.																																					
	10'	6'	78		0.98	67	0.98																																					
	12'	8'	49		0.61	42	0.61																																					
	16'	10'	33		0.41	21	0.30																																					
	Delivered Illuminance Rating: (DIR)		79 FC per W/Sq. Ft.		68 FC per W/Sq. Ft.																																							
	Recessed mounting Square rooms used for multiple units: RCR 2: Length & Width = Ceiling Ht. - 2.5' x 5.00 RCR 4: Length & Width = Ceiling Ht. - 2.5' x 2.50 * Average Footcandles at 2.5' Above Floor																																											
	0° - 20°	975	31%		Mounting Height AFF	FC at Center on Floor	Beam Diameter	FC at Beam Edge																																				
	5°	2656	0° - 30°		1870	60%	8'	41 fc	9.1'	14 fc																																		
15°	2544	0° - 40°	2501	80%	10'	27 fc	11.4'	9 fc																																				
25°	1768	0° - 60°	3000	96%	12'	18 fc	13.6'	6 fc																																				
35°	787	0° - 80°	3093	99%	14'	14 fc	15.9'	4 fc																																				
45°	358	0° - 90°	3099	100%	16'	10 fc	18.2'	3 fc																																				
55°	206	Total	3109	100%	20'	7 fc	22.7'	2 fc																																				
90°	2				24'	5 fc	27.3'	2 fc																																				
					28'	3 fc	31.8'	1 fc																																				

Delivered Lumens: 3109
Luminaire Watts: 38.4
LER: 80.96

CP at 0° (Nadir): 2653
CRI: 80+

Beam Angle: 60°
Spacing Ratio: 0.92

Lumen Multiplier: 10L x 0.18, 15L x 0.29, 20L x 0.39, 30L x 0.58, 40L x 0.78
CCT Multiplier: 27HK x 0.77, 30K x 0.96, 40K x 1.03, 50K x 1.04



PHOTOMETRIC DATA - 4" SQUARE WALL WASH

SGW4SQLEDFX 50L 35K XX CA0294FX MW WF SK

CANDLEPOWER CURVE TEST SP-01221	PERFORMANCE SUMMARY	REFERENCE DIAGRAM
------------------------------------	---------------------	-------------------

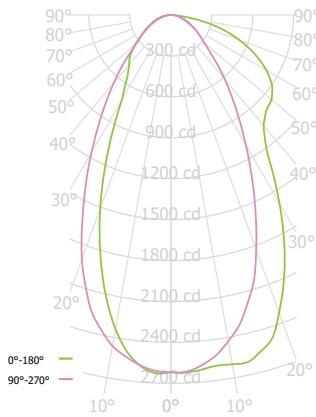

Delivered Lumens: 3259
 Luminaire Watts: 38.3
 LER: 85.09

CP at 0deg (Nadir): 2619
 CRI: 80+

Lumen Multiplier: 10L x 0.18, 15L x 0.29,
 20L x 0.39, 30L x 0.58,
 40L x 0.78

CCT Multiplier: 27HK x 0.77, 30K x
 0.96, 40K x 1.03, 50K x
 1.04

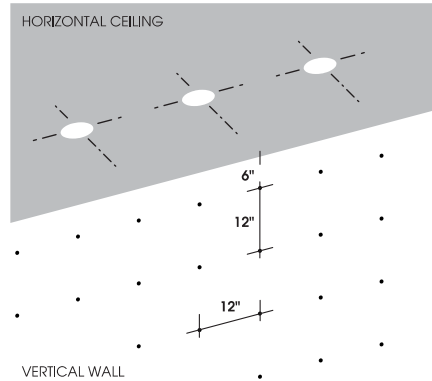

PERFORMANCE DATA - INITIAL ILLUMINATION (FOOTCANDLES) ON WALL - DIRECT LIGHT ONLY

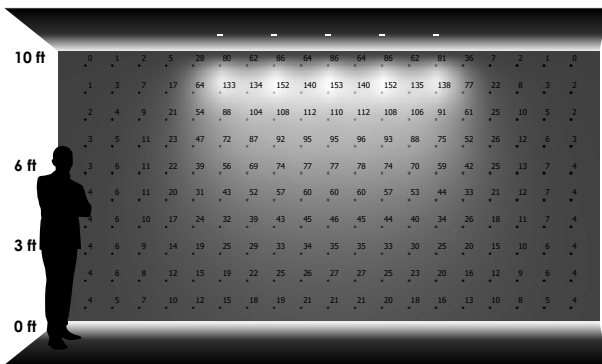

5 LUMINAIRES
 2'-0" away from wall
 2'-0" between luminaires

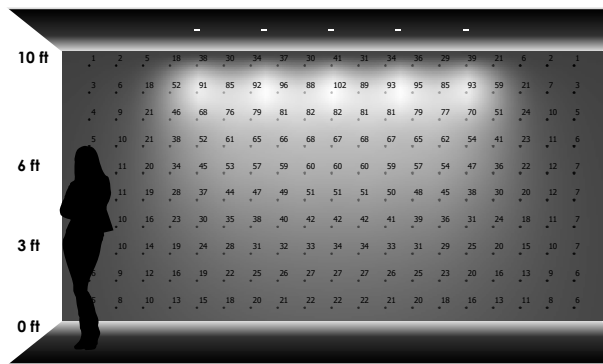

5 LUMINAIRES
 2'-6" away from wall
 2'-6" between luminaires

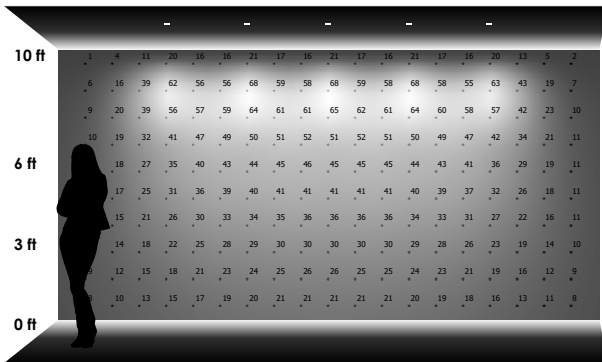

5 LUMINAIRES
 3'-0" away from wall
 3'-0" between luminaires

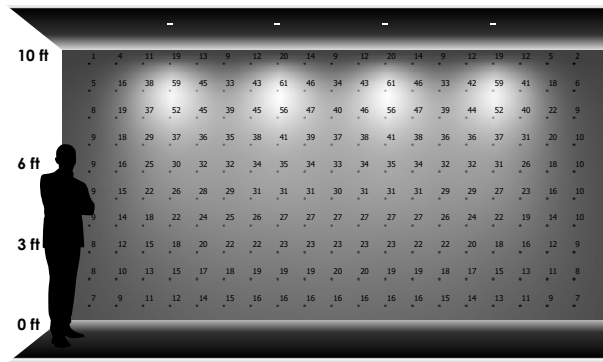

4 LUMINAIRES
 3'-0" away from wall
 4'-0" between luminaires



PHOTOMETRIC DATA - 4" SQUARE WALL WASH

SGW4SQLEDFX 50L 35K XX CA0294FX PT WF SK

CANDLEPOWER CURVE TEST SP-01221_1	PERFORMANCE SUMMARY	REFERENCE DIAGRAM
	<p>Delivered Lumens: 2863</p> <p>Luminaire Watts: 38.3</p> <p>LER: 74.75</p>	
	<p>CP at 0deg (Nadir): 2620</p> <p>CRI: 80+</p>	
	<p>Lumen Multiplier: 10L x 0.18, 15L x 0.29, 20L x 0.39, 30L x 0.58, 40L x 0.78</p> <p>CCT Multiplier: 27HK x 0.77, 30K x 0.96, 40K x 1.03, 50K x 1.04</p>	

PERFORMANCE DATA - INITIAL ILLUMINATION (FOOTCANDLES) ON WALL - DIRECT LIGHT ONLY

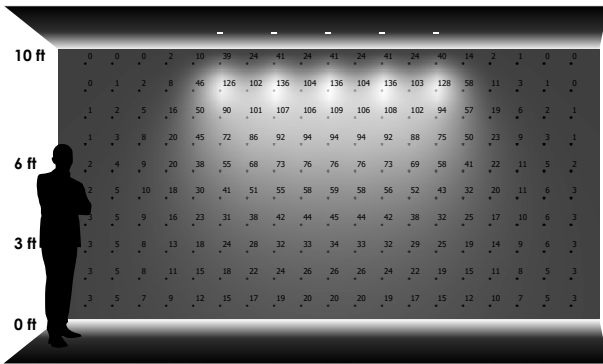

5 LUMINAIRES
2'-0" away from wall
2'-0" between luminaires

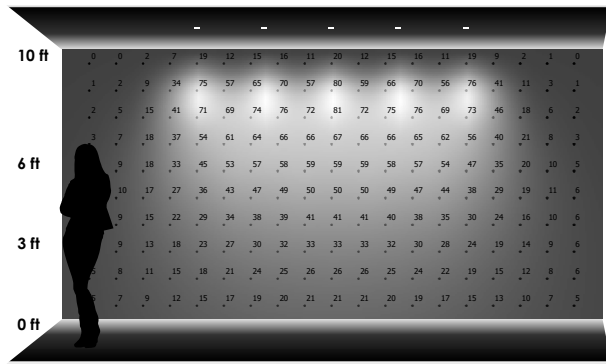

5 LUMINAIRES
2'-6" away from wall
2'-6" between luminaires

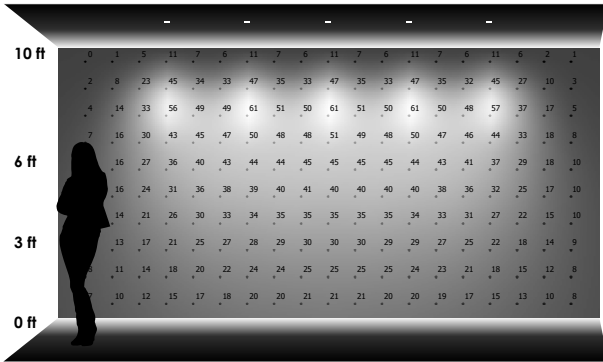

5 LUMINAIRES
3'-0" away from wall
3'-0" between luminaires

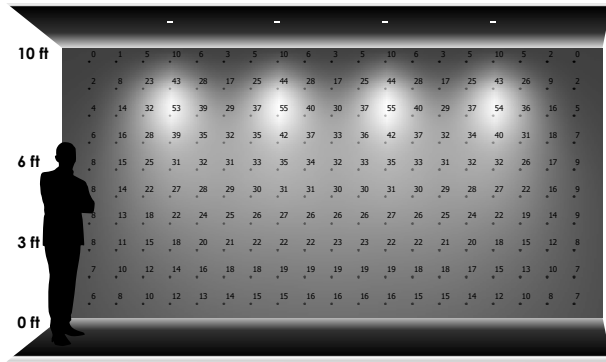

4 LUMINAIRES
3'-0" away from wall
4'-0" between luminaires

