

# 8" SQUARE DIRECT FOCUSED ILLUMINATION

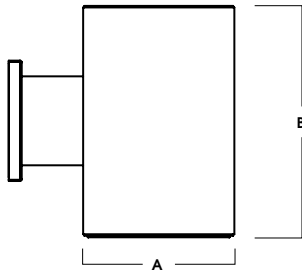

SERIES	A	B
C0812SQXT	8.0	12.1
C0816SQXT	8.0	16.1
C0824SQXT	8.0	24.1

Fixture Weight: 21.5 lbs

## C0812SQXT, C0816SQXT, C0824SQXT - WALL MOUNT

### APPLICATION

8" square x 12", 16" or 24" high 8" diameter series cylinder luminaire for accent and general illumination.

### FEATURES

Spectrum's Cylinder series provides traditional architectural style with high performance and energy efficient illumination. Rugged design with flexible mounting, finish and LED options make these extremely versatile fixtures. Quick change LED module with interchangeable optics for job site flexibility and fixture upgrade.

### FINISH

Multi-stage polyester powder-coat process applied on our dedicated paint lines. See mounting and color pages for standard finishes. All exposed materials are chromate pretreated to resist corrosion.

### ELECTRONICS

LED system features Xicato LED module with proprietary phosphor technology that provides consistent stable color with CCT control of +/- 100K over life of the light engine. Base CRI is 83 with 2-step MacAdam Ellipse binning. High CRI is 98 with 1 x 2-step MacAdam Ellipse binning. Variety of electronic 120V/277V and dimming drivers.

### CONSTRUCTION

Fabricated seamless aluminum fixture housing. Silicone gasket seals optical chamber. Specular primary optical reflectors provide high efficiency illumination. Impact resistant tempered glass lenses. Trim formed from .063 thick high purity aluminum and finished to specification.

### CODE COMPLIANCE

BAA compliant. ETL certified to meet US and Canadian standards. Suitable for dry or damp locations. Manufactured and tested to UL standards No. 1598/8750.

LUMENS / WATTAGE DATA				
PART NUMBER	SOURCE LUMENS	DELIVERED LUMENS <sup>2</sup>	SYSTEM WATTS <sup>3</sup>	LPW
C08xxSQXT10L	1000	740	9.1	81
C08xxSQXT13L	1300	998	13.0	77
C08xxSQXT20L	2000	1535	21.7	71
C08xxSQXT30L	3000	2302	32.6	71

SERIES	LUMENS <sup>1</sup>	CCT	OPTICS	DRIVER / DIMMING <sup>6</sup>	OPTIONS <sup>7</sup>	TRIM	MOUNTING <sup>11</sup>	FINISH <sup>12</sup>	
C0812SQXT 8" x 12" Cylinder	10L	1000 Lm	83 CRI	XN <sup>5</sup> 13° ND 22° MD 41° WD 48° XW 59°	EX Electronic Driver, 120V/277V DS10X 10%, 0-10V, 120V/277V DO10X 1%, 0-10V, 120V/277V DS2W1 ELV/MLV, 120V DLTE1 Lutron 2-Wire Forward Phase (MLV), 120V DL3EX 1% Lutron® EcoSystem® Fade, 120V/277V ED01X 0.1% eldoLED 120V/277V DALIX DALI Control	FS Fuse Holder and Fuse CR Corrosion Resistant	TCY <sup>6</sup> Same Color as Cylinder TPT Platinum Silver TCC Custom Color	WM3 Wall Mount 3" Extension WM5 Wall Mount 5" Extension	MW <sup>13</sup> Matte White MB <sup>13</sup> Matte Black PT <sup>13</sup> Platinum Silver CC Custom Color
	13L	1300 Lm	27K 2700K 30K 3000K 35K 3500K 40K 4000K						
C0816SQXT 8" x 16" Cylinder	20L	2000 Lm	83 CRI						
	30L	3000 Lm	27K 2700K 30K 3000K 35K 3500K 40K 4000K						
C0824SQXT 8" x 24" Cylinder			98 CRI <sup>4</sup>						
			27HK 2700K 30HK 3000K 35HK 3500K 40HK 4000K				EMERGENCY BATTERY OPTIONS EMR 7W Canopy Mounted EM EMEN 7W Remote EM	See Page 5 for Full Range of Color Options (83-90095)	

**EXAMPLE:** C0812SQXT20L35KWDEX/TPTSO/WM5/MW

**NOTES:**  
 1 Nominal Source Lumens at Any CCT 2 Nominal Delivered Lumens at 83 CRI at Any CCT with WD-TSG-SO 3 At 83 CRI 4 20L Max 5 13L Max/XN not Available with 98 CRI Option 6 Contact Factory for Additional Options  
 7 See Product Options Page for Details 8 Standard Finish 9 Standard Lens for XN, ND 10 Standard Lens for MD, WD, XW 11 See Mounting Page for Details on Components and Finishes 12 See Color Page for More Options/  
 Consult Factory for Special Finishes 13 Standard Finishes



PROJECT: \_\_\_\_\_  
 TYPE: \_\_\_\_\_



Dimensions and values shown are nominal. Spectrum Lighting continually works to improve products and reserves the right to make changes which may alter the performance or appearance of products.

# 8" SQUARE DIRECT

FOCUSED ILLUMINATION / FIXTURE OPTIONS



## SERIES SIZES

C0812SQXT

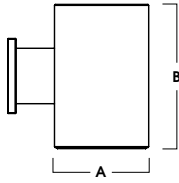

A	B
8.0	12.1
203.2 mm	307.3 mm

C0816SQXT

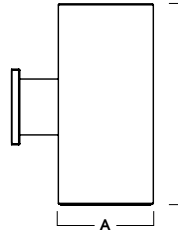
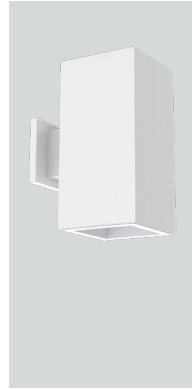

A	B
8.0	16.1
203.2 mm	408.9 mm

C0824SQXT

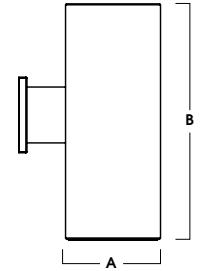

A	B
8.0	24.1
203.2 mm	612.1 mm

## STANDARD FINISHES

**MW**  
MATTE WHITE



**MB**  
MATTE BLACK



**PT**  
PLATINUM SILVER

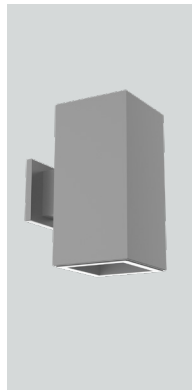

## WALL MOUNT DETAIL

**WM3**  
WALL MOUNT 3" EXTENSION

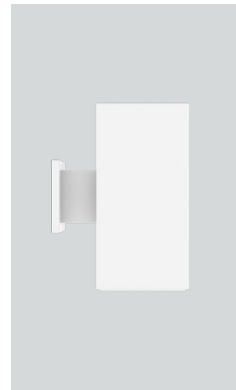

FRONT VIEW

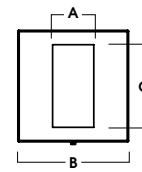

SIDE VIEW

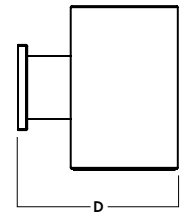

A	B	C	D
2.4	6.4	4.7	11.9
61.0 mm	162.6 mm	119.4 mm	302.3 mm

**WM5**  
WALL MOUNT 5" EXTENSION

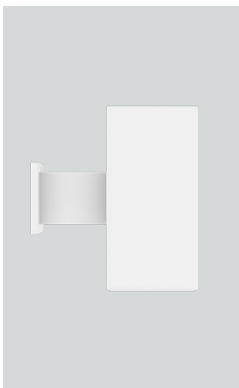

FRONT VIEW

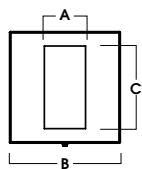

SIDE VIEW

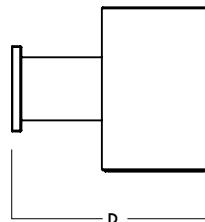

A	B	C	D
2.4	6.4	4.7	14.7
61.0 mm	162.6 mm	119.4 mm	373.4 mm

## EMERGENCY BATTERY OPTIONS

**EMRM\*** - 7W REMOTE EMERGENCY BATTERY  
(50' MAX)

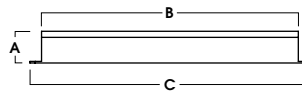

A	B	C
1.3	12.6	13.0

**EMEN\*** - 7W REMOTE EMERGENCY BATTERY  
WITH ENCLOSURE (50' MAX)

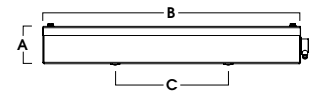

A	B	C
2.0	17.0	6.2

\*OTHER EM BATTERY SIZES AVAILABLE. CONSULT FACTORY

# 8" SQUARE DIRECT

## FOCUSED ILLUMINATION / PHOTOMETRIC DATA



### C08xxSQXT-30LxxK-NDEX-TSG-GL

### 30L NARROW - 83 CRI

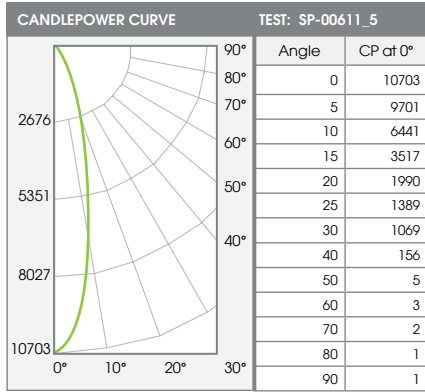

ZONAL LUMENS		
0-10	776	28%
0-20	1749	64%
0-30	2407	88%
0-40	2699	99%
0-60	2725	100%
0-80	2732	100%
0-90	2737	100%
Total Lumens	2739	100%

SINGLE UNIT: PERFORMANCE INITIAL FOOTCANDLES AND BEAM ANGLE DIAMETERS			
Mounting Height*	FC at Center	Diameter of Beam**	FC at Beam**
5.5'	354	2.1'	170
6.5'	253	2.5'	122
7.5'	190	2.9'	92
8.5'	148	3.3'	71
10.0'	107	3.9'	52
12.0'	74	4.7'	36
14.0'	55	5.5'	26
16.0'	42	6.2'	20

\* From aperture to horizontal surface below.  
\*\* At IESNA defined Beam Angle, to 50% Max. CP.

Delivered Lumens: 2739    CP @ 0° (Nadir): 10703    Spacing Ratio: 0.4  
 Luminaire Watts: 32.6    Beam Angle: 22.1°    Output Multipliers: 10L x 0.32, 13L x 0.43, 20L x 0.67  
 LER: 84    CRI: 83

### C08xxSQXT-30LxxK-MDEX-TSG-SO

### 30L MEDIUM - 83 CRI

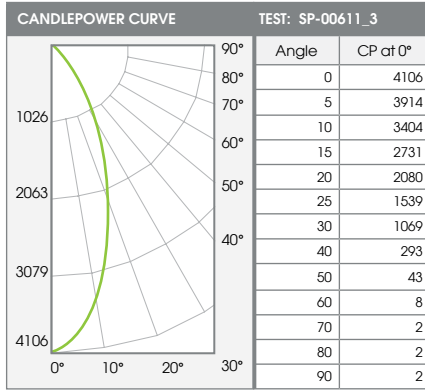

ZONAL LUMENS		
0-10	359	15%
0-20	1132	49%
0-30	1857	80%
0-40	2220	95%
0-60	2318	99%
0-80	2327	100%
0-90	2333	100%
Total Lumens	2334	100%

SINGLE UNIT: PERFORMANCE INITIAL FOOTCANDLES AND BEAM ANGLE DIAMETERS			
Mounting Height*	FC at Center	Diameter of Beam**	FC at Beam**
5.5'	136	4.1'	60
6.5'	97	4.9'	43
7.5'	73	5.6'	32
8.5'	57	6.4'	25
10.0'	41	7.5'	18
12.0'	29	9.0'	13
14.0'	21	10.5'	9
16.0'	16	12.0'	7

\* From aperture to horizontal surface below.  
\*\* At IESNA defined Beam Angle, to 50% Max. CP.

Delivered Lumens: 2334    CP @ 0° (Nadir): 4106    Spacing Ratio: 0.64  
 Luminaire Watts: 32.6    Beam Angle: 41.1°    Output Multipliers: 10L x 0.32, 13L x 0.43, 20L x 0.67  
 LER: 72    CRI: 83

### C08xxSQXT-30LxxK-WDEX-TSG-SO

### 30L WIDE - 83 CRI

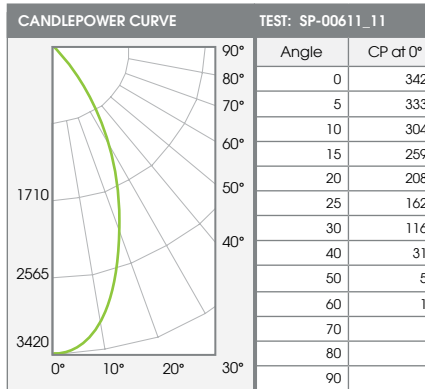

ZONAL LUMENS		
0-10	307	13%
0-20	1021	44%
0-30	1754	76%
0-40	2156	94%
0-60	2284	99%
0-80	2295	100%
0-90	2301	100%
Total Lumens	2302	100%

SINGLE UNIT: PERFORMANCE INITIAL FOOTCANDLES AND BEAM ANGLE DIAMETERS			
Mounting Height*	FC at Center	Diameter of Beam**	FC at Beam**
5.5'	113	4.9'	47
6.5'	81	5.8'	34
7.5'	61	6.7'	25
8.5'	47	7.6'	20
10.0'	34	8.9'	14
12.0'	24	10.7'	10
14.0'	17	12.5'	7
16.0'	13	14.2'	6

\* From aperture to horizontal surface below.  
\*\* At IESNA defined Beam Angle, to 50% Max. CP.

Delivered Lumens: 2302    CP @ 0° (Nadir): 3420    Spacing Ratio: 0.74  
 Luminaire Watts: 32.6    Beam Angle: 48°    Output Multipliers: 10L x 0.32, 13L x 0.43, 20L x 0.67  
 LER: 71    CRI: 83

# 8" SQUARE DIRECT

## FOCUSED ILLUMINATION / PHOTOMETRIC DATA



C08xxSQXT-30LxxK-XWEX-TSG-SO

30L XTRA WIDE - 83 CRI

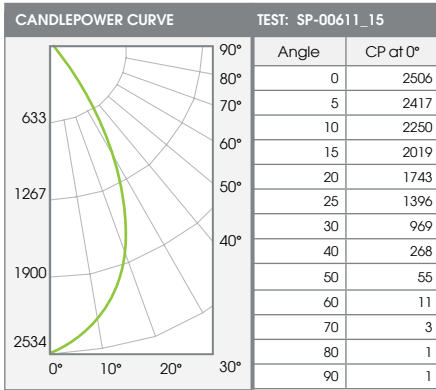

**ZONAL LUMENS**

0-10	232	10%
0-20	841	38%
0-30	1574	71%
0-40	2028	91%
0-60	2209	99%
0-80	2221	100%
0-90	2226	100%
Total Lumens	2227	100%

**SINGLE UNIT: PERFORMANCE**  
INITIAL FOOTCANDLES AND BEAM ANGLE DIAMETERS

Mounting Height*	FC at Center	Diameter of Beam**	FC at Beam**
5.5'	83	6.2'	31
6.5'	59	7.3'	22
7.5'	45	8.5'	17
8.5'	35	9.6'	13
10.0'	25	11.3'	10
12.0'	17	13.6'	7
14.0'	13	15.8'	5
16.0'	10	18.1'	4

\* From aperture to horizontal surface below.  
\*\* At IESNA defined Beam Angle, to 50% Max. CP.

Delivered Lumens: 2227  
Luminaire Watts: 32.6  
LER: 68

CP @ 0° (Nadir): 2506  
Beam Angle: 58.9°  
CRI: 83

Spacing Ratio: 0.84  
Output Multipliers: 10L x 0.32, 13L x 0.43, 20L x 0.67

# COLOR OPTIONS - POWDER COAT PAINT FINISHES

NOTE: NO PRINTED IMAGE CAN EQUAL THE EXACT COLOR OF FINISH ON METAL.  
SEE INDIVIDUAL SPECIFICATION SHEETS OR CONSULT FACTORY FOR ADDITIONAL INFORMATION.



## STANDARD CORD / STEM / CANOPY FINISHES

FIXTURE COLOR	STANDARD CORD COLOR	STANDARD CANOPY / STEM COLOR
Matte White, Textured White	Matte White	Matte White
Gloss White	Matte White	Gloss White
Matte Black, Textured Black	Matte Black	Matte Black
All Others	Matte Black	Same Color as Fixture
Custom Color	Contact Factory	Contact Factory

## PAINT TIMES

TIER	COST	AVERAGE PAINT TIME*
Tier 1 - Standard Finishes	\$	⌚
Tier 2 - Typical Finishes	\$\$	⌚⌚
Custom Color	Contact Factory	Contact Factory

\*CONTACT FACTORY FOR SPECIFIC PRODUCT LEAD TIMES

## TIER 1 - STANDARD FINISHES

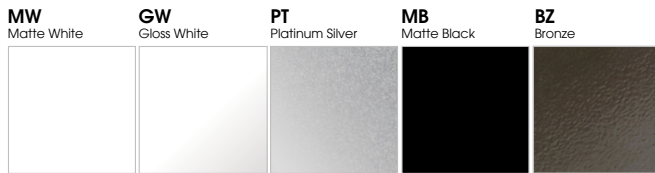

## TIER 2 - TYPICAL FINISHES

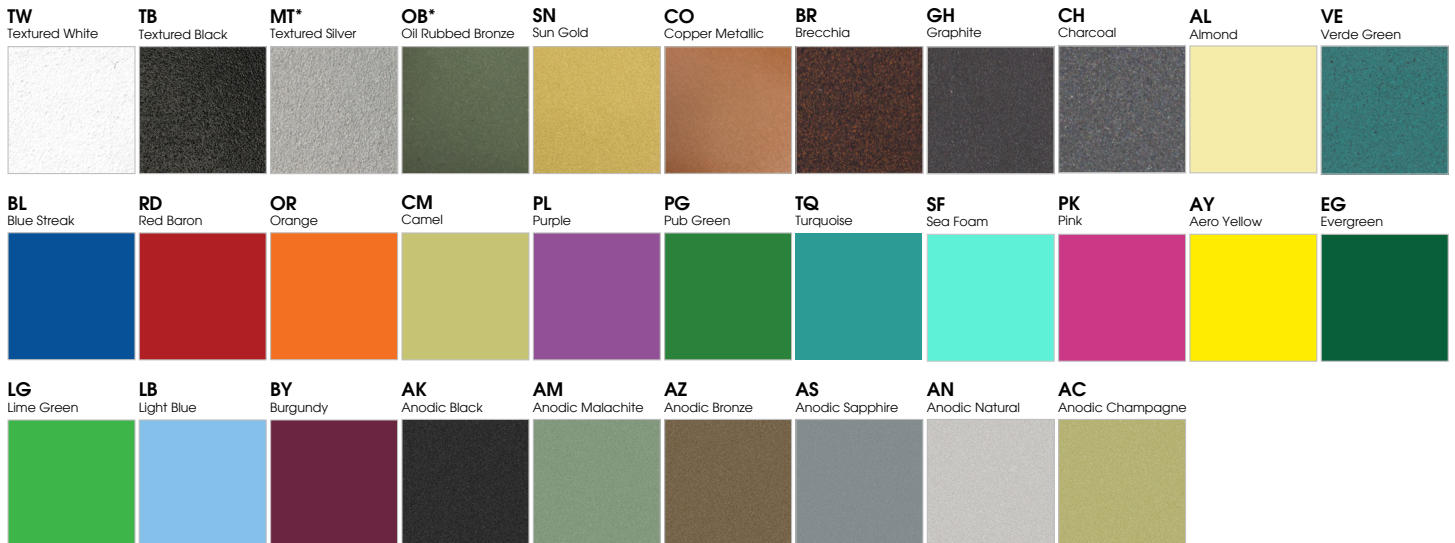

## CUSTOM COLOR FINISHES

CONTACT FACTORY

**CC**  
Custom Color



\*UNAVAILABLE FOR WET LOCATION