

PROJECT: _____
 TYPE: _____



3" ROUND FLANGED

SUPER SHALLOW IC NEW CONSTRUCTION

DIM TO WARM

Dimming from 3000K to 1600K, Spectrum's Infinium Dim To Warm series follows in the footsteps of older halogen lamps which turned warmer in color when dimmed.



NOMINAL LUMENS / WATTAGE DATA				
PART NUMBER	CCT RANGE	DELIVERED LUMENS ¹	SYSTEM WATTS	LPW
IF03RSF 007	27K-16K	502	7.3	69
IF03RSF 010	28K-16K	647	9.3	70
IF03RSF 015	30K-16K	1057	15.2	70

¹ Nominal Delivered Lumens at DD1 015 DL FL GP MW

AVAILABLE HOUSING TYPE

IF03RSF IC - IC New Construction

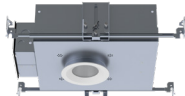

HOUSING						HOUSING OPTIONS					
SERIES	TYPE	EMITTER	CRI/CCT	LUMENS	OPTIONS	DIMMING		MOUNTING		BATTERY	
IF03RSF	IC IC New Construction	DW	DIM TO WARM			PR 1.25" Ceiling Extension	D1 1%, 0-10V	1	120V	B1 Expandable Bar Hangers	ER 7W Remote Battery
			DD1	30-16K	007			502 Lm	2		
				Dim to Warm	010		647 Lm				
			Nominal Delivered Lumens at DD1 015 DL FL GP MW			D3 1%, ELV/MLV Phase-Cut (120V)	1	120V			

AVAILABLE TRIM / MODULE TYPES



TRIM OPTIONS						SEPARATE ADDITIONAL ACCESSORIES	
TRIM TYPE	BEAM ¹	LENS	FINISH	FLANGE FINISH	OPTION		
DL Downlight	SP Spot (20°)	GN No Lens Not Available in Wet Location	MW Matte White	MF Matching Flange Default Selection with PH Trim Type	WL Wet Location Requires GP or GC Lens	GOOF RING	
PH Pinhole Downlight	NF Narrow Flood (26°)	GP Solite™ Micro Prism Lens	MB Matte Black	WF White Flange For Use with Non-White Trim Finish		GRIF03R	MW Matte White
	FL Flood (35°)	GC Clear Glass Lens	PT Platinum Silver				MB Matte Black
	WF Wide Flood (56°)		CC Custom Color				PT Platinum Silver
AA Adjustable Accent	NF Narrow Flood (29°)					BAR HANGERS	
	FL Flood (43°)					B2	27" Solid Bar Hangers
	WF Wide Flood (48°)					B4	24" C-Channel Bar Hangers
WW Wall Wash	WF Wide Flood	LW Wall Wash Lens					

¹ Nominal Beam Angles Shown

EXAMPLE: IF03RSFICDWDD1007/D12B1/DLNF GCMWFWL

Dimensions and values shown are nominal. Spectrum Lighting continually works to improve products and reserves the right to make changes which may alter the performance or appearance of products.



HOUSING DIMENSIONS

IF03RSF IC - SUPER SHALLOW IC NEW CONSTRUCTION

IC rated frame-in kit for new construction with direct insulation contact and CCEA (Chicago Plenum) compatibility.

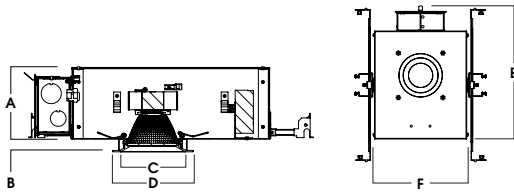

A	B	C	D	E	F
4.0	.625	3.6	4.5	13.2	9.5
101.6 mm	15.9 mm	91.4 mm	114.3 mm	335.3 mm	241.3 mm

Fixture Weight: 5.0 lbs

Ceiling Cutout: $\varnothing 3\frac{7}{8}$ "

TRIM / MODULE DATA

DL - DOWNLIGHT MODULE

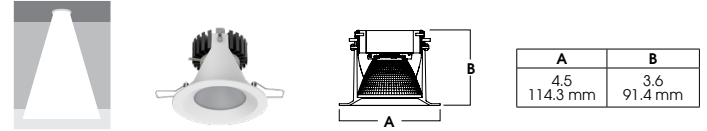

PH - PINHOLE DOWNLIGHT MODULE

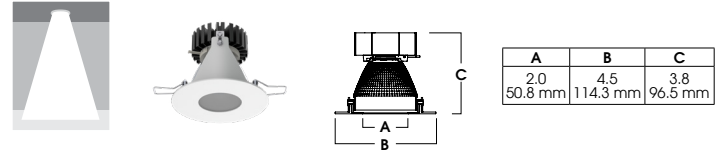

AA - ADJUSTABLE MODULE (30°)

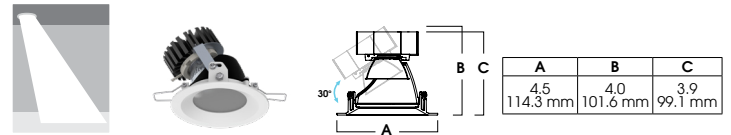

WW - WALL WASH MODULE

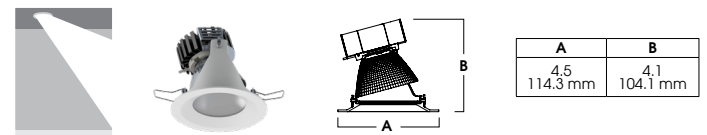

GRIF03R - 3" ROUND GOOF RING

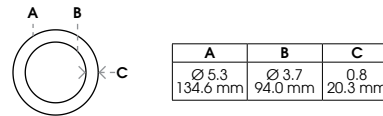

DIMMING BEHAVIOR

PHASE DIMMING (LINEAR)

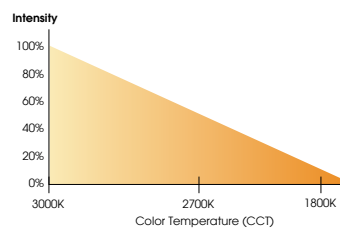

0-10V DIMMING (LOGARITHMIC)

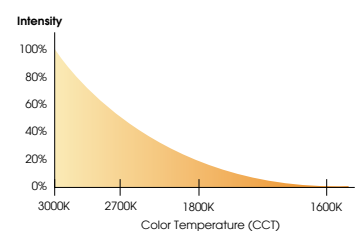

FEATURES

APPLICATION

Versatile super shallow plenum 3" round recessed LED luminaire with a 4" deep IC housing, featuring downlight, adjustable accent, wall wash and pinhole downlight trim options with insulated ceiling housing.

FEATURES

Two-stage optical system for smooth low glare light distribution. Zhaga International Standard LED module for ease of maintenance and replacement. Shallow plenum design. Tool-less LED module, driver, and J-Box access. Multi-Bar mounting brackets. Expandable bar hangers with horizontal range of 14.2"-26", and vertical adjustment of 2.325". Post-lock trim retention springs. Integral 0.625" collar, works with up to 1" ceiling. For thicker ceilings consult factory.

TRIM FINISH

A variety of architectural powdercoat finishes are available. Trims available with and without lens. Specify trim finish and flange finish.

ELECTRONICS

Dim to Warm offering a familiar dimming experience to traditional incandescent lamps (3000K-1600K). All options feature 3-step MacAdam Ellipse binning and 95 CRI 0-10V or phase-cut dimming to 1%, standard.

CONSTRUCTION

Housing/frame constructed of #20 ga. galvanized steel to resist corrosion. Self-flanged one piece die-cast aluminum trim is finished to specification. Passive machined aluminum heatsink.

CODE COMPLIANCE

BAA Compliant. ETL certified to meet US and Canadian standards. Suitable for dry or damp locations. Optional Wet Location. Manufactured and tested to UL standards No. 1598/8750. City of Chicago Environmental Air (CCEA), and Insulated Ceiling (IC) options available.



PHOTOMETRIC DATA - 3" ROUND SHALLOW

IF03RMx IC DWDD1015 DLSPGPM

CANDLEPOWER CURVE
TEST SP-00947_1_M-15L

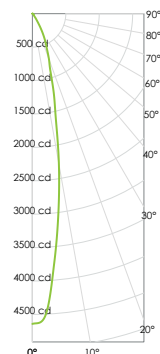

INTENSITY CANDELA 0° AZIMUTH		ZONAL LUMENS	
0.00°	0.00°	0° - 10°	314 31%
5.00°	4.642	0° - 20°	671 66%
10.00°	3.747	0° - 30°	887 87%
15.00°	2.283	0° - 40°	965 94%
20.00°	1.242	0° - 60°	1,001 98%
30.00°	240	0° - 80°	1,021 100%
40.00°	39	0° - 90°	1,022 100%
50.00°	19		
60.00°	15		
70.00°	7		
80.00°	2		
90.00°	0	Total	1,022 100%

SINGLE UNIT: PERFORMANCE INITIAL FOOTCANDLES BASED ON IES BEAM ANGLE			
Mounting Height AFF	FC at Center on Floor	Beam Diameter	FC at Beam Edge
5.5'	153 fc	1.9'	73 fc
6.5'	110 fc	2.3'	53 fc
7.5'	83 fc	2.6'	39 fc
8.5'	64 fc	3.0'	31 fc
10.0'	46 fc	3.5'	22 fc
12.0'	32 fc	4.2'	15 fc
14.0'	24 fc	4.9'	11 fc
16.0'	18 fc	5.6'	9 fc

MULTIPLE UNITS: PERFORMANCE 80/50/20% REFLECTANCES INITIAL FOOTCANDLES AND WATTS PER SQUARE FOOT					
Ceiling Height	Fixture Spacing	RCR 4		RCR 6	
		FC +	W/Sq. Ft.	FC +	W/Sq. Ft.
9'	2'	235	3.68	191	3.26
12'	2'	248	3.88	229	3.91
16'	4'	55	0.85	64	1.09
Delivered Illuminance Rating: (DIR)		64 FC per W/Sq. Ft.		59 FC per W/Sq. Ft.	
Recessed Mounting Square rooms used for multiple units: - RCR 4: Length & Width = Ceiling Ht. -2.5' x 2.50 - RCR 6: Length & Width = Ceiling Ht. -2.5' x 1.66 + Average Footcandles at 2.5' Above Floor					

Delivered Lumens: 1,022
Luminaire Watts: 15.2
LER: 67.24

CP at 0deg (Nadir): 4,642
CRI: 95

Beam Angle: 19.73
Spacing Ratio: 0.33

Lumen Multiplier: 7L x 0.38, 10L x 0.49
CCT Multiplier: N/A, dim to warm emitter

IF03RMx IC DWDD1015 DLNFGPMW

CANDLEPOWER CURVE
TEST SP-00947_2_M-15L

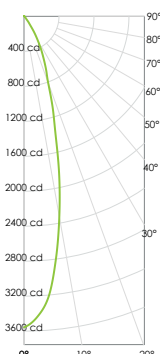

INTENSITY CANDELA 0° AZIMUTH		ZONAL LUMENS	
0.00°	0.00°	0° - 10°	279 27%
5.00°	3,557	0° - 20°	664 64%
10.00°	3,221	0° - 30°	896 87%
15.00°	1,392	0° - 40°	977 95%
20.00°	807	0° - 60°	1,011 98%
30.00°	308	0° - 80°	1,029 100%
40.00°	45	0° - 90°	1,030 100%
50.00°	19		
60.00°	16		
70.00°	12		
80.00°	4		
90.00°	1	Total	1,030 100%

SINGLE UNIT: PERFORMANCE INITIAL FOOTCANDLES BASED ON IES BEAM ANGLE			
Mounting Height AFF	FC at Center on Floor	Beam Diameter	FC at Beam Edge
5.5'	118 fc	2.5'	54 fc
6.5'	84 fc	3.0'	39 fc
7.5'	63 fc	3.4'	29 fc
8.5'	49 fc	3.9'	23 fc
10.0'	36 fc	4.6'	16 fc
12.0'	25 fc	5.5'	11 fc
14.0'	18 fc	6.4'	8 fc
16.0'	14 fc	7.4'	6 fc

MULTIPLE UNITS: PERFORMANCE 80/50/20% REFLECTANCES INITIAL FOOTCANDLES AND WATTS PER SQUARE FOOT					
Ceiling Height	Fixture Spacing	RCR 3		RCR 5	
		FC +	W/Sq. Ft.	FC +	W/Sq. Ft.
9'	2'	265	3.93	198	3.24
12'	4'	65	0.97	64	1.05
16'	6'	32	0.48	32	0.52
Delivered Illuminance Rating: (DIR)		67 FC per W/Sq. Ft.		61 FC per W/Sq. Ft.	
Recessed Mounting Square rooms used for multiple units: - RCR 3: Length & Width = Ceiling Ht. -2.5' x 3.33 - RCR 5: Length & Width = Ceiling Ht. -2.5' x 2.00 + Average Footcandles at 2.5' Above Floor					

Delivered Lumens: 1,030
Luminaire Watts: 15.2
LER: 67.76

CP at 0deg (Nadir): 3,557
CRI: 95

Beam Angle: 25.9
Spacing Ratio: 0.43

Lumen Multiplier: 7L x 0.38, 10L x 0.49
CCT Multiplier: N/A, dim to warm emitter

IF03RMx IC DWDD1014 DLFLGPMW

CANDLEPOWER CURVE
TEST SP-00947_3_M-15L

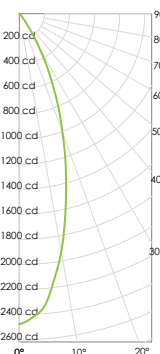

INTENSITY CANDELA 0° AZIMUTH		ZONAL LUMENS	
0.00°	0.00°	0° - 10°	211 20%
5.00°	2,475	0° - 20°	610 58%
10.00°	2,335	0° - 30°	907 86%
15.00°	1,926	0° - 40°	1,004 95%
20.00°	1,438	0° - 60°	1,038 98%
30.00°	1,005	0° - 80°	1,055 100%
40.00°	337	0° - 90°	1,056 100%
50.00°	41		
60.00°	16		
70.00°	13		
80.00°	9		
90.00°	2		
90.00°	1	Total	1,056 100%

SINGLE UNIT: PERFORMANCE INITIAL FOOTCANDLES BASED ON IES BEAM ANGLE			
Mounting Height AFF	FC at Center on Floor	Beam Diameter	FC at Beam Edge
5.5'	82 fc	3.4'	36 fc
6.5'	59 fc	4.1'	25 fc
7.5'	44 fc	4.7'	19 fc
8.5'	34 fc	5.3'	15 fc
10.0'	25 fc	6.2'	11 fc
12.0'	17 fc	7.5'	7 fc
14.0'	13 fc	8.7'	5 fc
16.0'	10 fc	10.0'	4 fc

MULTIPLE UNITS: PERFORMANCE 80/50/20% REFLECTANCES INITIAL FOOTCANDLES AND WATTS PER SQUARE FOOT					
Ceiling Height	Fixture Spacing	RCR 3		RCR 5	
		FC +	W/Sq. Ft.	FC +	W/Sq. Ft.
9'	2'	222	3.24	199	3.24
12'	4'	66	0.97	65	1.05
16'	6'	25	0.37	21	0.33
Delivered Illuminance Rating: (DIR)		68 FC per W/Sq. Ft.		62 FC per W/Sq. Ft.	
Recessed Mounting Square rooms used for multiple units: - RCR 3: Length & Width = Ceiling Ht. -2.5' x 3.33 - RCR 5: Length & Width = Ceiling Ht. -2.5' x 2.00 + Average Footcandles at 2.5' Above Floor					

Delivered Lumens: 1,056
Luminaire Watts: 15.2
LER: 69.47

CP at 0deg (Nadir): 2,475
CRI: 95

Beam Angle: 34.62
Spacing Ratio: 0.55

Lumen Multiplier: 7L x 0.38, 10L x 0.49
CCT Multiplier: N/A, dim to warm emitter



PHOTOMETRIC DATA - 3" ROUND SHALLOW

IF03RMx IC DWDD1015 DLWFGPMW

CANDLEPOWER CURVE TEST SP-00947_M-15L	INTENSITY CANDELA 0° AZIMUTH	ZONAL LUMENS		SINGLE UNIT: PERFORMANCE INITIAL FOOTCANDLES BASED ON IES BEAM ANGLE				MULTIPLE UNITS: PERFORMANCE 80/50/20% REFLECTANCES INITIAL FOOTCANDLES AND WATTS PER SQUARE FOOT						
		0° - 10°	105	11%	Mounting Height Aff	FC at Center on Floor	Beam Diameter	FC at Beam Edge	Ceiling Height	Fixture Spacing	RCR 2		RCR 4	
	0.00°	0° - 10° <td>105 <td>11% <td></td> <td></td> <td></td> <td></td> <td></td> <td></td> <td>FC *</td> <td>W/Sq. Ft.</td> <td>FC *</td> <td>W/Sq. Ft.</td> </td></td>	105 <td>11% <td></td> <td></td> <td></td> <td></td> <td></td> <td></td> <td>FC *</td> <td>W/Sq. Ft.</td> <td>FC *</td> <td>W/Sq. Ft.</td> </td>	11% <td></td> <td></td> <td></td> <td></td> <td></td> <td></td> <td>FC *</td> <td>W/Sq. Ft.</td> <td>FC *</td> <td>W/Sq. Ft.</td>							FC *	W/Sq. Ft.	FC *	W/Sq. Ft.
	0.00° 1,106	0° - 20°	378	40%	5.5'	37 fc	5.9'	13 fc	9'	4'	59	0.92	51	0.92
	5.00° 1,102	0° - 30°	692	73%	6.5'	26 fc	7.0'	9 fc	12'	6'	27	0.43	24	0.43
	10.00° 1,053	0° - 40°	852	90%	7.5'	20 fc	8.0'	7 fc	16'	10'	10	0.16	7	0.12
	15.00° 980	0° - 60°	931	98%	8.5'	15 fc	9.1'	5 fc	Delivered Illuminance Rating: (DIR)		64 FC per W/Sq. Ft.		55 FC per W/Sq. Ft.	
	20.00° 879	0° - 80°	947	100%	10.0'	11 fc	10.7'	4 fc	Recessed Mounting Square rooms used for multiple units: - RCR 2: Length & Width = Ceiling Ht. -2.5' x 5.00 - RCR 4: Length & Width = Ceiling Ht. -2.5' x 2.50 * Average Footcandles at 2.5' Above Floor					
	30.00° 464	0° - 90°	949	100%	12.0'	8 fc	12.9'	3 fc						
	40.00° 121	Total	949	100%	14.0'	6 fc	15.0'	2 fc						
	50.00° 41				16.0'	4 fc	17.2'	1 fc						
	60.00° 17													
	70.00° 7													
	80.00° 2													
	90.00° 1													

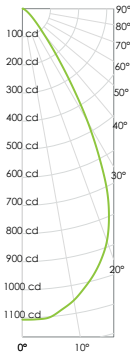

Delivered Lumens: **949**
 Luminaire Watts: **15.2**
 LER: **62.43**

CP at 0deg (Nadir): **1,106**
 CR: **95**

Beam Angle: **56.4**
 Spacing Ratio: **0.9**

Lumen Multiplier: **7L x 0.38, 10L x 0.49**
 CCT Multiplier: **N/A, dim to warm emitter**



PHOTOMETRIC DATA - 3" ROUND SHALLOW WALL WASH

IF03RMx IC DWDD1015 WWWFLWMW

CANDLEPOWER CURVE TEST SP-00951_M-15L	PERFORMANCE SUMMARY	REFERENCE DIAGRAM
--	---------------------	-------------------

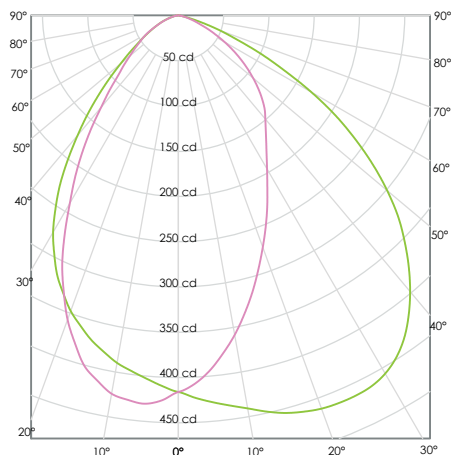

Delivered Lumens: 726
 Luminaire Watts: 15.2
 LER: 47.76
 CP at 0deg (Nadir): 416
 CRI: 95
 Lumen Multiplier: 7L x 0.38, 10L x 0.49
 CCT Multiplier: N/A, dim to warm emitter

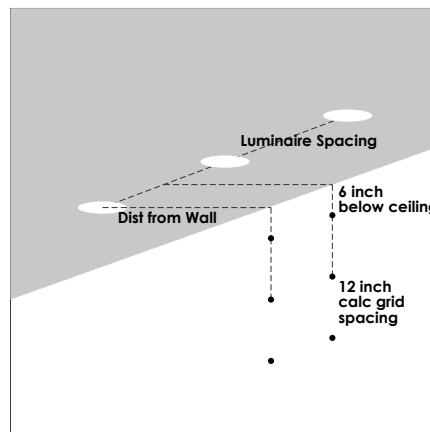

PERFORMANCE DATA - INITIAL ILLUMINATION (FOOTCANDLES) ON WALL - DIRECT LIGHT ONLY

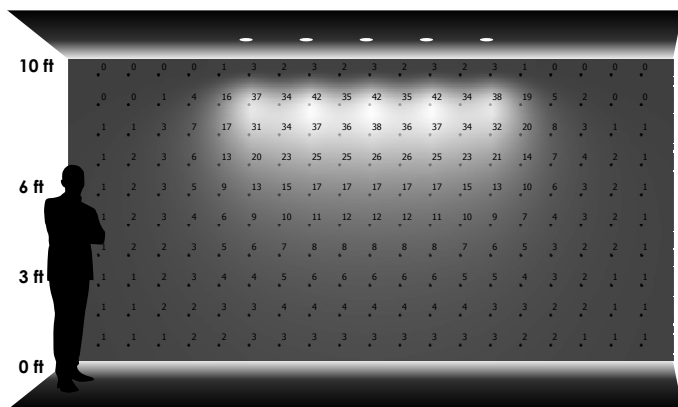

5 LUMINAIRES
 2' away from wall
 2' between luminaires

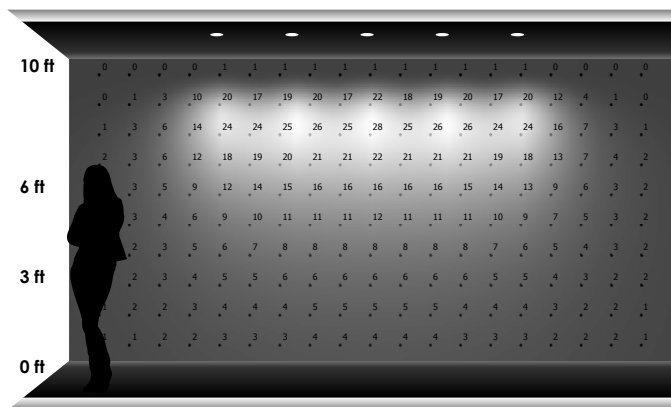

5 LUMINAIRES
 2'-6" away from wall
 2'-6" between luminaires

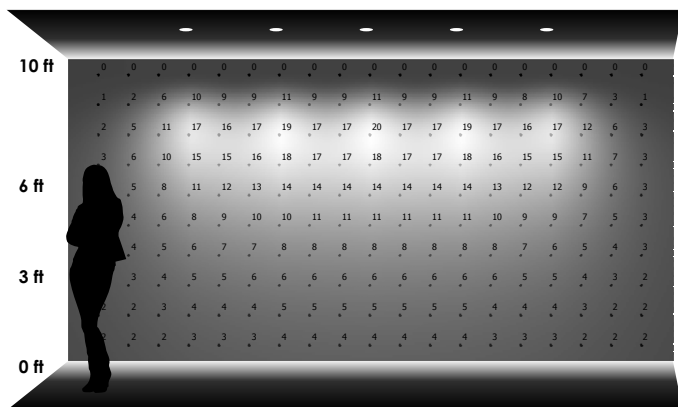

5 LUMINAIRES
 3' away from wall
 3' between luminaires

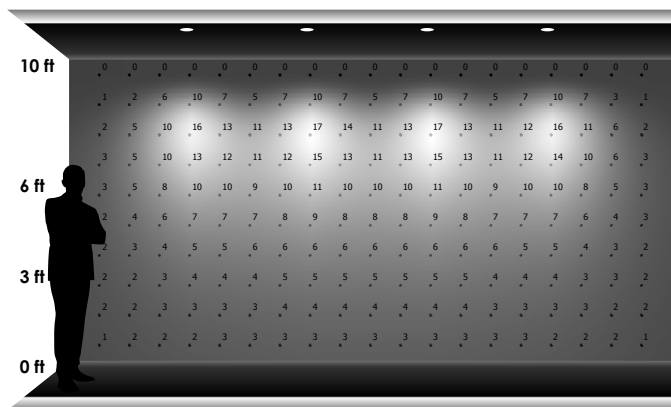

4 LUMINAIRES
 3' away from wall
 4' between luminaires

