



**ZEVA**  
**DAMP / WET LOCATION**  
**CLASSIC SHAPES**

PROJECT: \_\_\_\_\_

QUANTITY: \_\_\_\_\_ TYPE: \_\_\_\_\_



ZV1206GV  
 PT - Platinum Silver



ZV1206GV  
 CO - Copper Metallic



ZV1206GV  
 MB - Matte Black

SERIES		LUMENS <sup>1</sup>		CCT	DRIVER / DIMMING <sup>2</sup>		ACCESSORIES <sup>3</sup>		MOUNTING <sup>5</sup>		INTERIOR <sup>7</sup>		FINISH <sup>7</sup>		WET KIT		
ZV1206GV	15L	1500 Lm		80 CRI	DX DS2W1	1%, 0-10V, 120V/277V ELV/MLV, 120V	MFO <sup>4</sup> FJO	2" Frosted Mini 2" Frosted Tall	WALL MOUNT		MWF <sup>8</sup> CCI FCI	Matte White Custom Color Fixture Color Interior	MW <sup>8</sup> MB <sup>8</sup> PT <sup>8</sup> CC	Matte White Matte Black Platinum Silver Custom Color	WLKA	Wet Location Kit	
				WM Wall Mount													
				90 CRI					CEILING MOUNT		See Page 5 for Full Range of Color Options (83-90083)		See Page 5 for Full Range of Color Options (83-90083)				
				27HK 2700K 30HK 3000K 35HK 3500K 40HK 4000K					RDC <sup>5</sup> HM <sup>6</sup> AT <sup>6</sup> PM <sup>6</sup> CD <sup>6</sup> CM <sup>6</sup>	Small Driver Canopy Hang Straight Hang Straight All Thread Rigid Pendant Mount Cord / Cable Mount Cord Mount							

EXAMPLE: ZV1206GV15L30KDXMF0/RDC5HM36MWIMB

**NOTES:**  
 1 Nominal Source Lumens at 35K 2 Contact Factory for Additional Options 3 Enclosure Required - Choose One Option 4 Standard Enclosure  
 5 See Mounting Page for Details on Components and Finishes 6 Specify Length in Inches: See Mounting Page for Available Lengths  
 7 See Color Page for More Options/Consult Factory for Special Finishes 8 Standard Finishes





**ZEVA**  
**DAMP / WET LOCATION**  
**CLASSIC SHAPES**

LUMENS / WATTAGE DATA				
PART NUMBER	SOURCE LUMENS <sup>1</sup>	DELIVERED LUMENS <sup>2</sup>	SYSTEM WATTS	LPW
ZV1206GV15L	1500	1106	11	100

<sup>1</sup> Nominal Source Lumens at 35K <sup>2</sup> Nominal Delivered Lumens at 35K

**HOUSING DIMENSIONS**

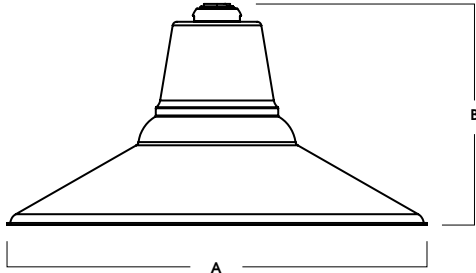

A	B
12.0	6.3
304.8 mm	160.0 mm

**APPLICATION**

The Zeva Series are a small diameter RLM style shade. Inspired by vintage lighting styling with modern light sources and materials. 1100 delivered lumens (nominal). The wide range of options for illumination, mounting, enclosures, and finishes allows for creative luminaire specification.

**ELECTRONICS**

Proprietary solid-state light engine available in various color temperatures. Color quality and consistency of 80 CRI (typical), 3 SDCM. Selection of electronic constant current dimming drivers available. Driver and light engine are field serviceable for future replacement or upgrades. For higher CRI and custom configurations, consult factory.

**CONSTRUCTION**

Shades are spun in our factory from 0.063 high purity aluminum. Passive aluminum heatsink optimized for emitter life and performance. Die-cast aluminum coupler accepts variety of mounting types. Wall mount canopies are spun aluminum with nickel plated hardware. Wall arms are formed and fabricated 3/8 aluminum pipe. Choice of diffused, evenly illuminated emitter enclosures eliminate direct source visibility and are free from emitter pixelation.

**FINISH**

Multi-stage polyester powder-coat process applied on our dedicated paint lines. All exposed materials are chromate pretreated to resist corrosion. Standard and custom finishes are available. Interior is Matte White unless specified

**CODE COMPLIANCE**

BAA compliant. ETL listed to meet US and Canadian standards. Suitable for dry or damp locations. Wet Location Option. 5 year limited warranty on all components. Proudly designed and manufactured in Massachusetts.

**ENCLOSURES**

**MFO**  
2" FROSTED MINI



**FJO**  
2" FROSTED TALL



**WALL MOUNT**

(SEE MOUNTING PAGES FOR MORE OPTIONS & DIMENSIONS.)

**WM**  
WALL MOUNT



ZV1206GV SHOWN WITH WM

**CEILING MOUNT**

(SEE MOUNTING PAGES FOR MORE OPTIONS & CANOPY DIMENSIONS.)

**HM / AT / PM**  
HANG STRAIGHT / ALL THREAD / PENDANT



ZV1206GV SHOWN WITH RDC5PM

**CD**  
CORD / CABLE MOUNT



ZV1206GV SHOWN WITH RDC5CD

**CM**  
CORD MOUNT



ZV1206GV SHOWN WITH RDC5CM



**ZEVA**  
**DAMP / WET LOCATION**  
**CLASSIC SHAPES / PHOTOMETRIC DATA**

ZV1206GV 15L 35K XX MF0 XX MWI

CANDLEPOWER CURVE TEST SP-01142	INTENSITY CANDELA 0° AZIMUTH	ZONAL LUMENS		SINGLE UNIT: PERFORMANCE DIRECT FOOTCANDLES BASED ON DOWNLIGHT ONLY				MULTIPLE UNITS: PERFORMANCE 80/50/20% REFLECTANCES INITIAL FOOTCANDLES AND WATTS PER SQUARE FOOT							
		0° - 10°	32	3%	Mounting Height AFF	FC at Center on Floor	Beam Diameter	FC at Beam Edge	Ceiling Height	Fixture Spacing	RCR 3		RCR 5		
	0°	336	0° - 10°	32	3%	6.5'	8 fc	27.4'	0 fc	12'	6'	21	0.28	12	0.20
	5°	334	0° - 20°	124	11%	7.5'	6 fc	31.6'	0 fc	15'	8'	11	0.14	6	0.10
	15°	326	0° - 30°	266	24%	8.5'	5 fc	35.8'	0 fc	18'	10'	7	0.09	4	0.06
	25°	305	0° - 40°	439	40%	10.0'	3 fc	42.1'	0 fc	Delivered Illuminance Rating: (DIR)		76 FC per W/Sq. Ft.		59 FC per W/Sq. Ft.	
	35°	278	0° - 60°	822	74%	12.0'	2 fc	50.5'	0 fc	2' Suspension Length to luminous aperture Square rooms used for multiple units: RCR 3: Length & Width = Ceiling Ht. - 5.5' x 3.33 RCR 5: Length & Width = Ceiling Ht. - 5.5' x 2.00 * Average Footcandles at 2.5' Above Floor					
	45°	253	0° - 80°	1,074	97%	14.0'	2 fc	58.9'	0 fc						
	55°	223	Downlight	1,095	99%	16.0'	1 fc	67.3'	0 fc						
	90°	4	Total	1,106	100%	20.0'	1 fc	84.2'	0 fc						

Delivered Lumens: **1,106**  
 Luminaire Watts: **11**  
 LER: **100.55**

CP at 0° (Nadir): **336**  
 CRI: **80+**

Beam Angle: **129°**  
 Spacing Ratio: **1.29**

Lumen Multiplier: **Only 15L available**  
 CCT Multiplier: **27K x 0.97, 30K x 0.99, 40K x 1.03**



# MOUNTING & ACCESSORIES

SOME OPTIONS NOT AVAILABLE ON ALL FIXTURES. CONSULT SPECIFICATION SHEETS. SEE INDIVIDUAL SPECIFICATION SHEETS OR CONSULT FACTORY FOR ADDITIONAL INFORMATION. NOTE: THIS IS TYPICAL OF RLM SPECIFICATION FOR MOUNTING. INDIVIDUAL FIXTURES OR PROJECTS MAY HAVE SPECIALIZED REQUIREMENTS.



## WALL MOUNTING

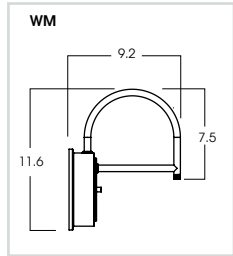

## CEILING MOUNTING

<p><b>RDC5</b> - SMALL DRIVER CANOPY (STANDARD) MOUNTS TO 4" OCTO J-BOX</p>	<p><b>HM*</b> HANG STRAIGHT 45° SWIVEL 5/8" OD STEM - 3/8" IP</p> <p>ORDER: HM (Length) SPECIFY LENGTH: HM3 - 3"    HM24 - 24" HM6 - 6"    HM36 - 36" HM12 - 12"    HM48 - 48" HM18 - 18"    HM72 - 72" HMLC(XX) Custom Length (Specify in Inches)</p>	<p><b>PM*</b> RIGID PENDANT MOUNT RIGID 5/8" OD STEM - 3/8" IP</p> <p>ORDER: PM (Length) SPECIFY LENGTH: PM3 - 3"    PM24 - 24" PM6 - 6"    PM36 - 36" PM12 - 12"    PM48 - 48" PM18 - 18"    PM72 - 72" PMLC(XX) Custom Length (Specify in Inches)</p>	<p><b>AT**</b> HANG STRAIGHT ALL THREAD 45° SWIVEL 5/8" OD STEM - 1/4" IP</p> <p>ORDER: AT (Length) SPECIFY LENGTH: AT12 - 12" AT24 - 24" AT36 - 36" AT48 - 48" AT60 - 60" AT72 - 72"</p> <p><small>FIELD CUT THREADED PIPE FIELD LENGTH THREADED CUT PIPE COVERED UP BACKSIDE SWAN THREADED PIPE SLIP PIPE COVER OVER THREADED PIPE</small></p>	<p><b>CD</b> CORD / CABLE MOUNT SJ CORD WITH 1/16 SS CABLE</p> <p>ORDER: CD (Length) SPECIFY LENGTH: CD36 - 36" CD72 - 72" CD144 - 144" CDLC(XX) Custom Length (Specify in Inches)</p>	<p><b>CM</b> CORD MOUNT SJ CORD WITH STRAIN RELIEF</p> <p>ORDER: CM (Length) SPECIFY LENGTH: CM36 - 36" CM72 - 72" CM144 - 144" CMLC(XX) Custom Length (Specify in Inches)</p>
---	--	---	--	--	--

\*MAXIMUM ONE PIECE STEM LENGTH IS 72". \*\*MAXIMUM ONE PIECE STEM LENGTH IS 36". LONGER LENGTHS ARE POSSIBLE USING MULTIPLE STEMS AND COUPLERS.  
\*\*ORDER IN 12" INCREMENTS. ODD SIZES MAY BE FIELD CUT



# COLOR OPTIONS - POWDER COAT PAINT FINISHES

NOTE: NO PRINTED IMAGE CAN EQUAL THE EXACT COLOR OF FINISH ON METAL.  
SEE INDIVIDUAL SPECIFICATION SHEETS OR CONSULT FACTORY FOR ADDITIONAL INFORMATION.



## STANDARD CORD / STEM / CANOPY FINISHES

FIXTURE COLOR	STANDARD CORD COLOR	STANDARD CANOPY / STEM COLOR
Matte White, Textured White	Matte White	Matte White
Gloss White	Matte White	Gloss White
Matte Black, Gloss Black, Textured Black	Matte Black	Matte Black
All Others	Matte Black	Same Color as Fixture
Custom Color	Contact Factory	Contact Factory

## PAINT TIMES

TIER	COST	AVERAGE PAINT TIME*
Tier 1 - Standard Finishes	\$	⓪
Tier 2 - Typical Finishes	\$\$	⓪⓪
Tier 3 - Special Metal Finishes	\$\$\$	⓪⓪⓪
Custom Color	Contact Factory	Contact Factory

\*CONTACT FACTORY FOR SPECIFIC PRODUCT LEAD TIMES

## TIER 1 - STANDARD FINISHES

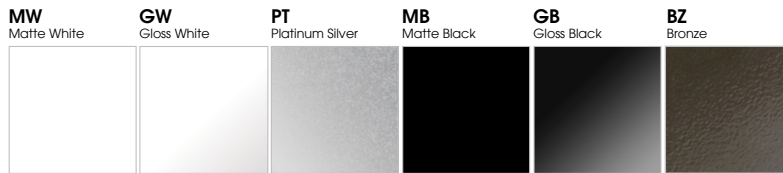

## TIER 2 - TYPICAL FINISHES



## TIER 3 - SPECIAL METAL FINISHES

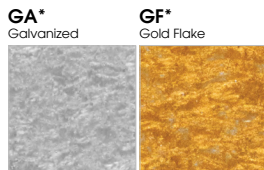

## CUSTOM COLOR FINISHES

CONTACT FACTORY

**CC**  
Custom Color



\*UNAVAILABLE FOR WET LOCATION

