

8" ROUND DIRECT / INDIRECT FOCUSED ILLUMINATION

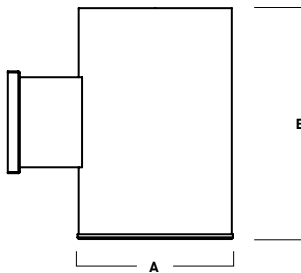

SERIES	A	B
C0812UDXT	8.0	12.1
C0816UDXT	8.0	16.1
C0824UDXT	8.0	24.1

Fixture Weight: 25.5 lbs

C0812UDXT, C0816UDXT, C0824UDXT - WALL MOUNT

APPLICATION

8" round x 12", 16" or 24" high direct / indirect 8" diameter series cylinder luminaire for accent and general illumination.

FEATURES

Spectrum's Cylinder series provides traditional architectural style with high performance and energy efficient illumination. Rugged design with flexible mounting, finish and LED options make these extremely versatile fixtures. Quick change LED module with interchangeable optics for job site flexibility and fixture upgrade.

FINISH

Multi-stage polyester powder-coat process applied on our dedicated paint lines. See mounting and color pages for standard finishes. All exposed materials are chromate pre-treated to resist corrosion.

ELECTRONICS

LED system features Xicato LED module with proprietary phosphor technology that provides consistent stable color with CCT control of +/- 100K over life of the light engine. Base CRI is 83 with 2-step MacAdam Ellipse binning. High CRI is 98 with 1 x 2-step MacAdam Ellipse binning. Variety of electronic 120V/277V and dimming drivers. 1 or 2 circuit operation.

CONSTRUCTION

Fabricated seamless aluminum fixture housing. Silicone gasket seals optical chamber. Specular primary optical reflectors provide high efficiency illumination. Impact resistant tempered glass lenses. Stainless steel hardware with galvanized steel brackets to resist corrosion. Trim formed from .063 thick high purity aluminum and finished to specification.

CODE COMPLIANCE

BAA compliant. ETL certified to meet US and Canadian standards. Suitable for dry or damp locations. Wet Location Option. Manufactured and tested to UL standards No. 1598/8750.

LUMENS / WATTAGE DATA

PART NUMBER	SOURCE LUMENS	DELIVERED LUMENS ²	SYSTEM WATTS ³	LPW
C0824UDXT10Lx2	2000	1497	18.2	82
C0824UDXT13Lx2	2600	2017	26.0	78
C0824UDXT20Lx2	4000	3103	43.4	71

SERIES	UPLIGHT ⁶		DOWNLIGHT		CCT	DRIVER / DIMMING ⁷	OPTIONS ⁸	TRIM	MOUNTING ¹¹	FINISH ¹²
C0812UDXT⁴ 8" x 12" Cylinder	10L 1000 Lm	XN 11°	10L 1000 Lm	XN 12°	83 CRI	EX Electronic Driver, 120V/277V	WL Wet Location	TSG Semi Diffuse Low Iridescent Clear	WM3 Wall Mount 3" Extension WM5 Wall Mount 5" Extension	MW¹³ Matte White MB¹³ Matte Black PT¹³ Platinum Silver CC Custom Color
		ND 23°		ND 22°						
C0816UDXT⁵ 8" x 16" Cylinder	13L 1300 Lm	MD 37°	13L 1300 Lm	MD 39°	83 CRI	DS10X 10%, 0-10V, 120V/277V	CR Corrosion Resistant	TCC Custom Color	EMRM 7W Remote EM EMEN 7W Remote with Enclosure	
		WD 42°		WD 46°						
C0824UDXT⁵ 8" x 24" Cylinder	20L 2000 Lm	XW 58°	20L 2000 Lm	XW 57°	98 CRI	DS2W1 ELV/MLV, 120V		GL⁹ Clear Glass Lens SO¹⁰ Micro Prism Solite™ Lens FG Frosted Glass Lens	EMERGENCY BATTERY OPTIONS	

EXAMPLE: C0824UDXT20LND20LMD35KEX/TSGSO/WM3/MW

NOTES:

1 Nominal Source Lumens At Any CCT 2 Nominal Delivered Lumens at 83 CRI at Any CCT with WD-GL, WD-TSG-SO 3 At 83 CRI 4 98 CRI 13L Max, XN 80 CRI 13L Max, XN 98 CRI 10L Max 5 XN 80 CRI 13L Max, XN 98 CRI 10L Max 6 1/4" Clear Glass Only 7 Contact Factory for Additional Options 8 See Product Options Page for Details 9 Standard Lens for All Indirect and Direct: XN, ND 10 Standard Lens for All Direct: MD, WD, XW 11 See Mounting Page for Details on Components and Finishes 12 Reference Color Sheet Located on Product Webpage for Full List of Available Colors 13 Standard Finishes



PROJECT: _____
TYPE: _____



Dimensions and values shown are nominal. Spectrum Lighting continually works to improve products and reserves the right to make changes which may alter the performance or appearance of products.

8" ROUND DIRECT / INDIRECT

FOCUSED ILLUMINATION / FIXTURE OPTIONS



SERIES SIZES

CO812DXT

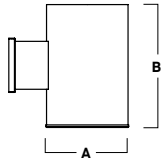

A	B
8.0	12.1
203.2 mm	307.3 mm

CO816DXT

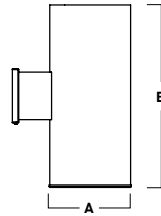

A	B
8.0	16.1
203.2 mm	408.9 mm

CO824DXT

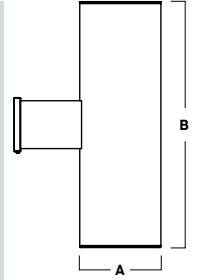
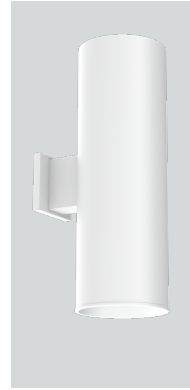

A	B
8.0	24.1
203.2 mm	612.1 mm

STANDARD FINISHES

MW
MATTE WHITE



MB
MATTE BLACK



PT
PLATINUM SILVER



WALL MOUNT DETAIL

WM3
WALL MOUNT 3" EXTENSION



FRONT VIEW

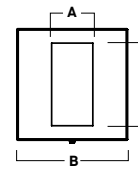

SIDE VIEW

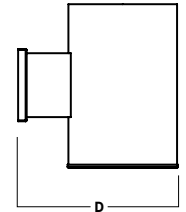

A	B	C	D
2.4	6.4	4.7	11.7
61.0 mm	162.6 mm	119.4 mm	297.2 mm

WM5
WALL MOUNT 5" EXTENSION



FRONT VIEW

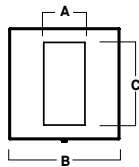

SIDE VIEW

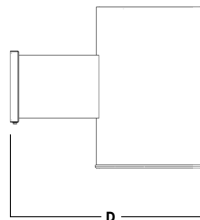

A	B	C	D
2.4	6.4	4.7	14.5
61.0 mm	162.6 mm	119.4 mm	368.3 mm

EMERGENCY BATTERY OPTIONS

EMRM* - 7W REMOTE EMERGENCY BATTERY
(50' MAX)



A	B	C
1.3	12.6	13.0

EMEN* - 7W REMOTE EMERGENCY BATTERY
WITH ENCLOSURE (50' MAX)

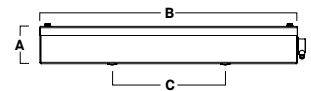

A	B	C
2.0	17.0	6.2

*OTHER EM BATTERY SIZES AVAILABLE, CONSULT FACTORY

8" ROUND DIRECT / INDIRECT

FOCUSED ILLUMINATION / PHOTOMETRIC DATA



C0824UDXT-13LXNGL-13LXN-xxKEX-TSG-GLxxx

13Lx2 XTRA NARROW - 83 CRI

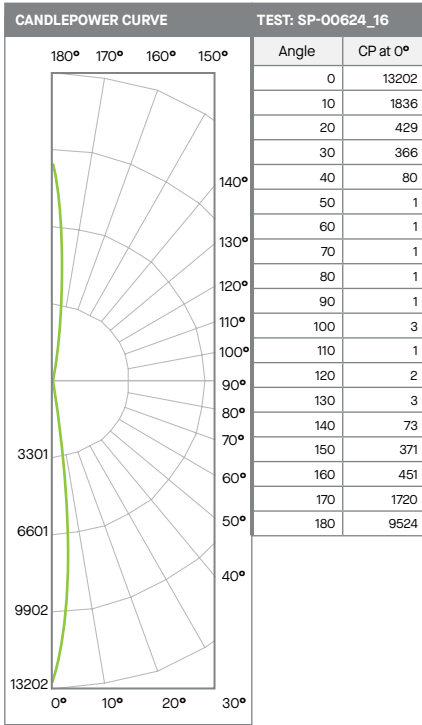

ZONAL LUMENS		
0-20	807	39%
0-40	1138	55%
0-60	1154	55%
0-90	1157	56%
90-120	8	0%
90-150	170	8%
90-180	924	44%
Total Lumens	2081	100%

SINGLE UNIT: PERFORMANCE INITIAL FOOTCANDLES AND BEAM ANGLE DIAMETERS			
Mounting Height*	FC at Center	Diameter of Beam**	FC at Beam**
5.5'	436	1.1'	216
6.5'	312	1.3'	155
7.5'	235	1.5'	116
8.5'	183	1.7'	90
10.0'	132	2.0'	65
12.0'	92	2.4'	45
14.0'	67	2.8'	33
16.0'	52	3.2'	26

SINGLE UNIT: PERFORMANCE INITIAL FOOTCANDLES AND BEAM ANGLE DIAMETERS			
Mounting Height*	FC at Center	Diameter of Beam**	FC at Beam**
4.0'	825	0.8'	409
5.0'	528	1.0'	261
6.0'	367	1.2'	182
8.0'	206	1.6'	102
10.0'	132	2.0'	65
12.0'	92	2.4'	45
14.0'	67	2.8'	33
16.0'	52	3.2'	26

Delivered Lumens: 2081 CP @ 0° (Nadir): 13202 Spacing Ratio: N/A
 Luminaire Watts: 36.8 Direct Beam Angle: 11.5° Output Multipliers: 10L x 0.74
 LER: 57 Indirect Beam Angle: 11.3°
 CRI: 83

C0824UDXT-20LNDGL-20LND-xxKEX-TSG-GLxxx

20Lx2 NARROW - 83 CRI

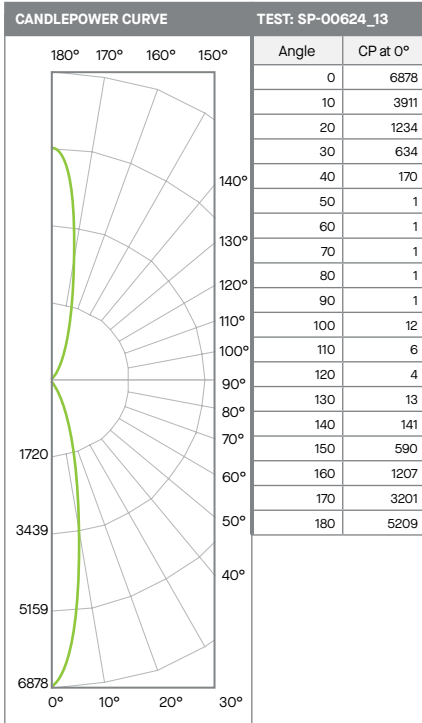

ZONAL LUMENS		
0-20	1135	33%
0-40	1802	53%
0-60	1844	54%
0-90	1847	54%
90-120	30	1%
90-150	280	8%
90-180	1568	46%
Total Lumens	3414	100%

SINGLE UNIT: PERFORMANCE INITIAL FOOTCANDLES AND BEAM ANGLE DIAMETERS			
Mounting Height*	FC at Center	Diameter of Beam**	FC at Beam**
5.5'	227	2.0'	110
6.5'	163	2.4'	79
7.5'	122	2.8'	59
8.5'	95	3.1'	46
10.0'	69	3.7'	33
12.0'	48	4.4'	23
14.0'	35	5.2'	17
16.0'	27	5.9'	13

SINGLE UNIT: PERFORMANCE INITIAL FOOTCANDLES AND BEAM ANGLE DIAMETERS			
Mounting Height*	FC at Center	Diameter of Beam**	FC at Beam**
4.0'	430	1.6'	206
5.0'	275	2.0'	132
6.0'	191	2.5'	92
8.0'	107	3.3'	52
10.0'	69	4.1'	33
12.0'	48	4.9'	23
14.0'	35	5.7'	17
16.0'	27	6.5'	13

Delivered Lumens: 3414 CP @ 0° (Nadir): 6878 Spacing Ratio: N/A
 Luminaire Watts: 43.4 Direct Beam Angle: 20.9° Output Multipliers: 10L x 0.48, 13L x 0.65
 LER: 79 Indirect Beam Angle: 23.1°
 CRI: 83

8" ROUND DIRECT / INDIRECT

FOCUSED ILLUMINATION / PHOTOMETRIC DATA



C0824UDXT-20LMDGL-20LMD-xxKEX-TSG-SOxxx

20Lx2 MEDIUM - 83 CRI

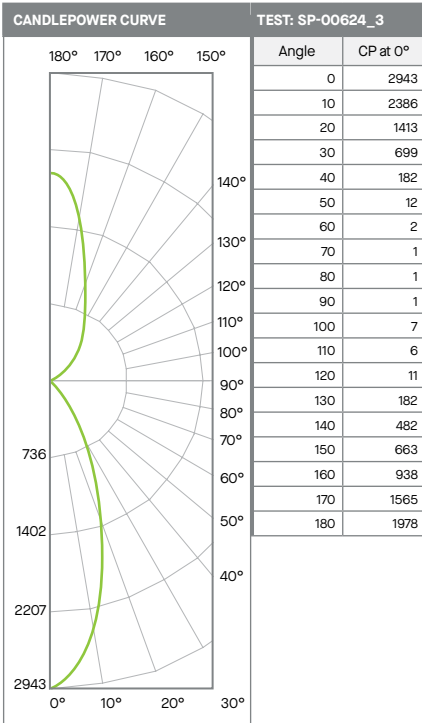

Beam Angle	Lumens	%
0-20	773	25%
0-40	1503	48%
0-60	1564	50%
0-90	1567	51%
90-120	18	1%
90-150	675	22%
90-180	1534	49%
Total Lumens	3101	100%

Mounting Height*	FC at Center	Diameter of Beam**	FC at Beam**
5.5'	97	4.0'	43
6.5'	70	4.7'	31
7.5'	52	5.4'	23
8.5'	41	6.1'	18
10.0'	29	7.2'	13
12.0'	20	8.6'	9
14.0'	15	10.1'	7
16.0'	11	11.5'	5

Mounting Height*	FC at Center	Diameter of Beam**	FC at Beam**
4.0'	184	2.6'	83
5.0'	118	3.3'	53
6.0'	82	4.0'	37
8.0'	46	5.3'	21
10.0'	29	6.6'	13
12.0'	20	7.9'	9
14.0'	15	9.3'	7
16.0'	11	10.6'	5

Delivered Lumens: 3101
Luminaire Watts: 4.34
LER: 71

CP @ 0° (Nadir): 2943
Direct Beam Angle: 39.6°
Indirect Beam Angle: 36.6°
CRI: 83

Spacing Ratio: N/A
Output Multipliers: 10L x 0.48, 13L x 0.65

C0824UDXT-20LWDGL-20LWD-xxKEX-TSG-SOxxx

20Lx2 WIDE - 83 CRI

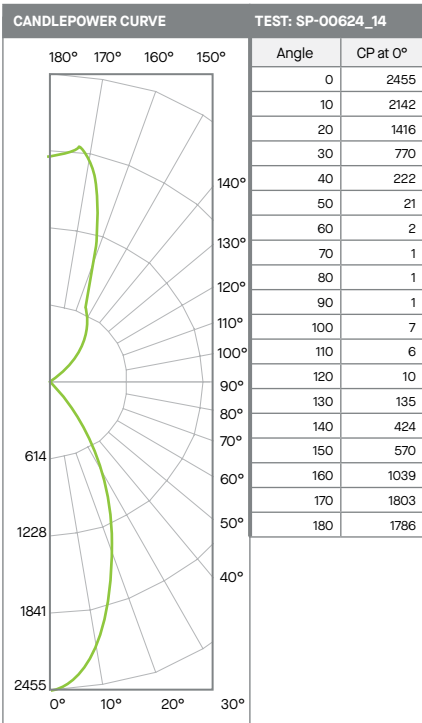

Beam Angle	Lumens	%
0-20	712	23%
0-40	1501	48%
0-60	1578	51%
0-90	1581	51%
90-120	18	1%
90-150	599	19%
90-180	1522	49%
Total Lumens	3103	100%

Mounting Height*	FC at Center	Diameter of Beam**	FC at Beam**
5.5'	81	4.7'	34
6.5'	58	5.5'	25
7.5'	44	6.4'	18
8.5'	34	7.2'	14
10.0'	25	8.5'	10
12.0'	17	10.2'	7
14.0'	13	11.9'	5
16.0'	10	13.6'	4

Mounting Height*	FC at Center	Diameter of Beam**	FC at Beam**
4.0'	153	3.1'	67
5.0'	98	3.8'	43
6.0'	68	4.6'	30
8.0'	38	6.2'	17
10.0'	25	7.7'	11
12.0'	17	9.2'	7
14.0'	13	10.8'	5
16.0'	10	12.3'	4

Delivered Lumens: 3103
Luminaire Watts: 43.4
LER: 71

CP @ 0° (Nadir): 2455
Direct Beam Angle: 46.0°
Indirect Beam Angle: 42.1°
CRI: 83

Spacing Ratio: N/A
Output Multipliers: 10L x 0.48, 13L x 0.65

8" ROUND DIRECT / INDIRECT

FOCUSED ILLUMINATION / PHOTOMETRIC DATA



C0824UDXT-20LXWGL-20LXW-xxKEX-TSG-Soxxx

20Lx2 XTRA NARROW - 83 CRI

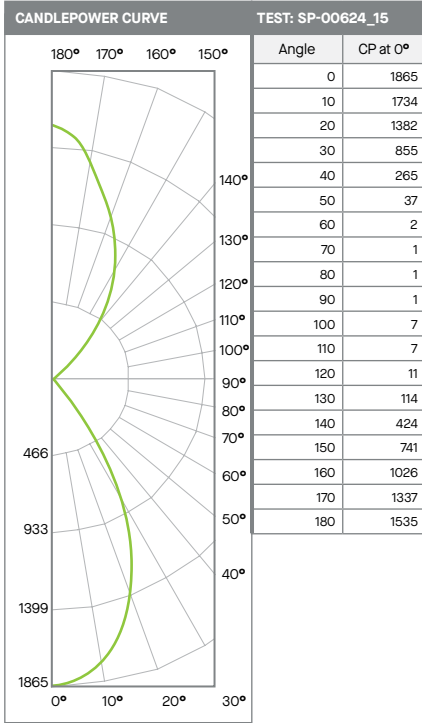

Angle	CP at 0°
0	1865
10	1734
20	1382
30	855
40	265
50	37
60	2
70	1
80	1
90	1
100	7
110	7
120	11
130	114
140	424
150	741
160	1026
170	1337
180	1535

Zone	Lumens	%
0-20	611	20%
0-40	1483	48%
0-60	1594	52%
0-90	1597	52%
90-120	19	1%
90-150	612	20%
90-180	1479	48%
Total Lumens	3076	100%

Mounting Height*	FC at Center	Diameter of Beam**	FC at Beam**
5.5'	62	6.2'	23
6.5'	44	7.3'	17
7.5'	33	8.4'	13
8.5'	26	9.6'	10
10.0'	19	11.2'	7
12.0'	13	13.5'	5
14.0'	10	15.7'	4
16.0'	7	18.0'	3

Mounting Height*	FC at Center	Diameter of Beam**	FC at Beam**
4.0'	117	4.4'	45
5.0'	75	5.6'	29
6.0'	52	6.7'	20
8.0'	29	8.9'	11
10.0'	19	11.1'	7
12.0'	13	13.3'	5
14.0'	10	15.6'	4
16.0'	7	17.8'	3

Delivered Lumens: 3076
Luminaire Watts: 43.4
LER: 71

CP @ 0° (Nadir): 1865
Direct Beam Angle: 58.7°
Indirect Beam Angle: 58.1°
CRI: 83

Spacing Ratio: N/A
Output Multipliers: 10L x 0.48, 13L x 0.65

* From aperture to horizontal surface below.
** At IESNA defined Beam Angle, to 50% Max. CP.

* From aperture to horizontal surface below.
** At IESNA defined Beam Angle, to 50% Max. CP.