

# 12" ROUND DIRECT / INDIRECT GENERAL ILLUMINATION

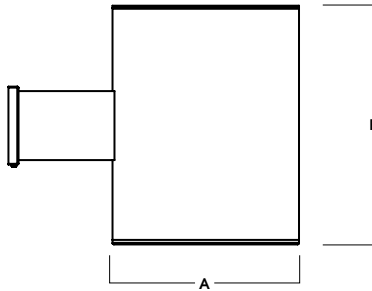

A	B
11.7 297.2 mm	16.2 411.5 mm

## C1216UDGV - WALL MOUNT

### APPLICATION

12" round x 16" high cylinder with direct/indirect performance for auditorium and gathering spaces.

### FEATURES

Spectrum's Cylinder series provides traditional architectural style with energy efficient illumination. Rugged design with flexible mounting, make these extremely versatile fixtures.

### FINISH

Multi-stage polyester powder-coat process applied on our dedicated paint lines. All exposed materials are chromate pretreated to resist corrosion.

### ELECTRONICS

GV LED system features high brightness white Samsung LED's. 3-step MacAdam Ellipse binning. Standard CRI: 85+. Higher CRI, R9 and custom LED configurations are available; consult factory. Variety of electronic 120V/277V and dimming drivers.

### CONSTRUCTION

Seamless aluminum fixture housing. Passive machined aluminum heatsink. Stainless steel hardware with galvanized steel brackets to resist corrosion.

### CODE COMPLIANCE

BAA compliant. ETL certified to meet US and Canadian standards. Suitable for dry or damp locations. Wet Location Option. Manufactured and tested to UL standards No. 1598/8750.

LUMENS / WATTAGE DATA				
PART NUMBER	SOURCE LUMENS <sup>1</sup>	DELIVERED LUMENS <sup>2</sup>	SYSTEM WATTS	LPW
C1216UDGV15L15L	3000	2139	20	107
C1216UDGV27L27L	5400	3734	36	104
C1216UDGV37L37L	7400	5477	52	105
C1216UDGV37L55L	9200	6736	65	104

SERIES	LUMENS <sup>1</sup>	CCT	DRIVER / DIMMING <sup>4</sup>	OPTIONS <sup>6</sup>	TRIM	MOUNTING <sup>9</sup>	FINISH <sup>10</sup>	
C1216UDGV	UPLIGHT <sup>3</sup>	DOWNLIGHT	27K 2700K 30K 3000K 35K 3500K 40K 4000K 50K 5000K	EX Electronic Driver, 120V/277V DS10X 10%, 0-10V, 120V/277V DO10X 1%, 0-10V, 120V/277V DS2W1 ELV / MLV, 120V DMXS <sup>5</sup> DMX Standard Configuration DMXC <sup>5</sup> DMX Non-Standard Custom	WL <sup>7</sup> Wet Location 2CIR 2 Circuit (2 Cords)	TSG Semi Diffuse Low Iridescence Clear Same TCY Color as Cylinder TCC Custom Color	WM5 Wall Mount 5" Extension	MW <sup>11</sup> Matte White MB <sup>11</sup> Matte Black PT <sup>11</sup> Platinum Silver CC Custom Color
	15L 1500 Lm 27L 2700 Lm 37L 3700 Lm	15L 1500 Lm 27L 2700 Lm 37L 3700 Lm 55L 5500 Lm				DOWN LENS SO <sup>8</sup> Micro Prism Solite™ Lens FG Frosted Glass Lens	EMERGENCY BATTERY OPTIONS EMRM 7W Remote EM	See Page 5 for Full Range of Color Options (83-90095)

**EXAMPLE:** C1216UDGV27L37L35KEX/TSGSO/WM5/PT

#### NOTES:

1 Nominal Source Lumens at 35K 2 Nominal Delivered Lumens at 35K with SO-TSG-SO 3 ¼" Clear Glass Only 4 Contact Factory for Additional Options 5 Contact Factory 6 See Product Options Page For Details 7 Lenses Required 8 Standard Lens 9 See Mounting Page for Details on Components and Finishes 10 See Color Page for More Options/Consult Factory for Special Finishes 11 Standard Finishes



PROJECT: \_\_\_\_\_  
TYPE: \_\_\_\_\_



Dimensions and values shown are nominal. Spectrum Lighting continually works to improve products and reserves the right to make changes which may alter the performance or appearance of products.

# 12" ROUND DIRECT / INDIRECT

## GENERAL ILLUMINATION / FIXTURE OPTIONS



### STANDARD FINISHES

**MW**  
MATTE WHITE



**MB**  
MATTE BLACK



**PT**  
PLATINUM SILVER



### WALL MOUNT DETAIL

**WM5**  
WALL MOUNT 5" EXTENSION



FRONT VIEW

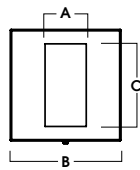

SIDE VIEW

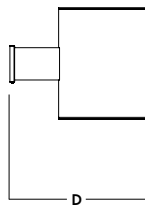

A	B	C	D
2.4	6.4	4.7	18.2
61.0 mm	162.6 mm	119.4 mm	462.3 mm

### EMERGENCY BATTERY OPTIONS

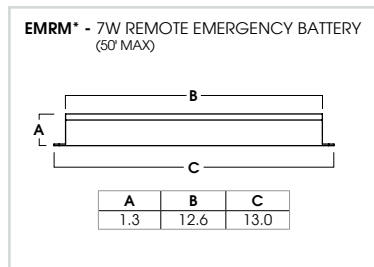

\*OTHER EM BATTERY SIZES AVAILABLE, CONSULT FACTORY

# 12" ROUND DIRECT / INDIRECT

## GENERAL ILLUMINATION / PHOTOMETRIC DATA



C1216UDGV-37L35K-EX-TSG-SO\_Up 37L - 85 CRI

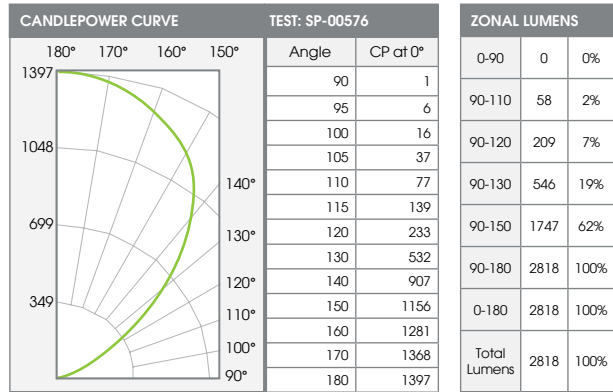

Delivered Lumens: 2818 CP @ 0° (Nadir): 1 Spacing Ratio: N/A  
 Luminaire Watts: 26 Beam Angle: 91.4° Output Multipliers: 15L x 0.39, 27L x 0.68  
 LER: 108 CRI: 84

C1216UDGV-37L55L-35KEX-SO-TSG-SO-MW(Up\_Down) 37L-55L - 85 CRI

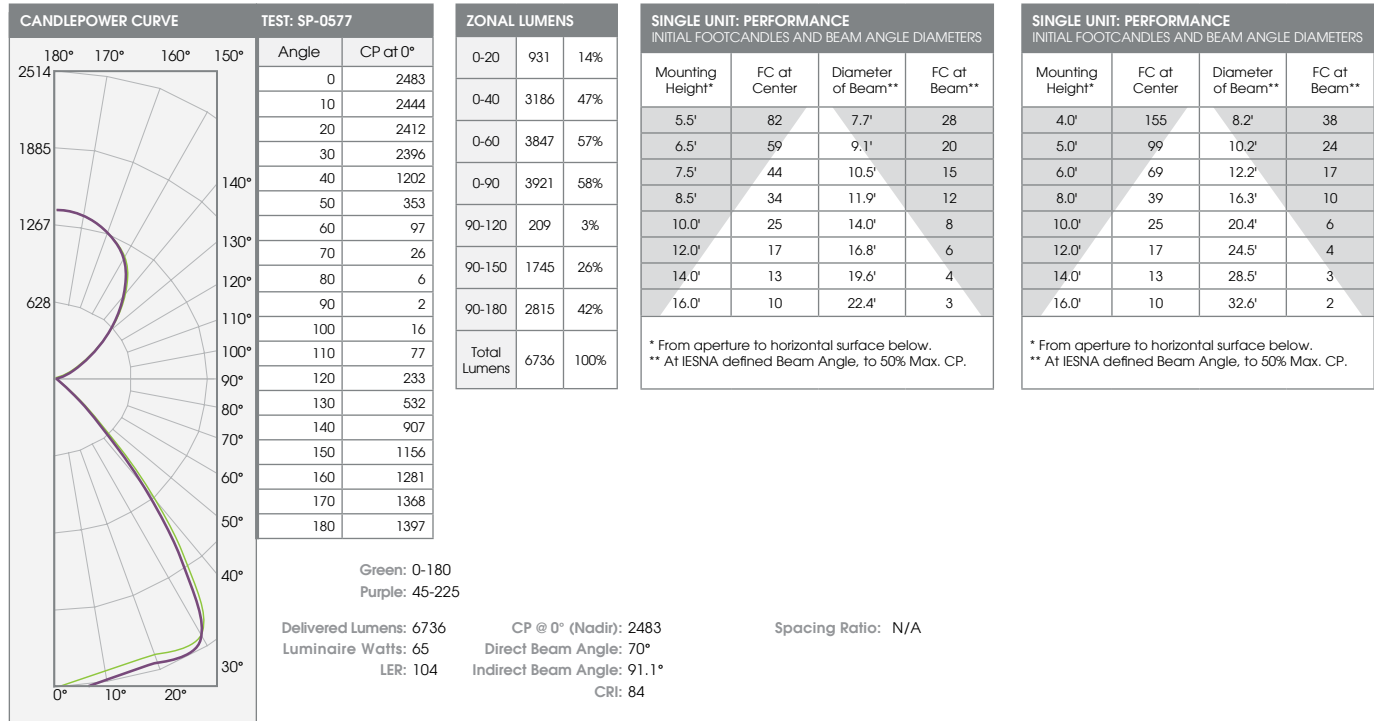

# 12" ROUND DIRECT / INDIRECT

## GENERAL ILLUMINATION / PHOTOMETRIC DATA



C1216UDGV-55L35K-EX-TSG-SO\_Down

55L - 85 CRI

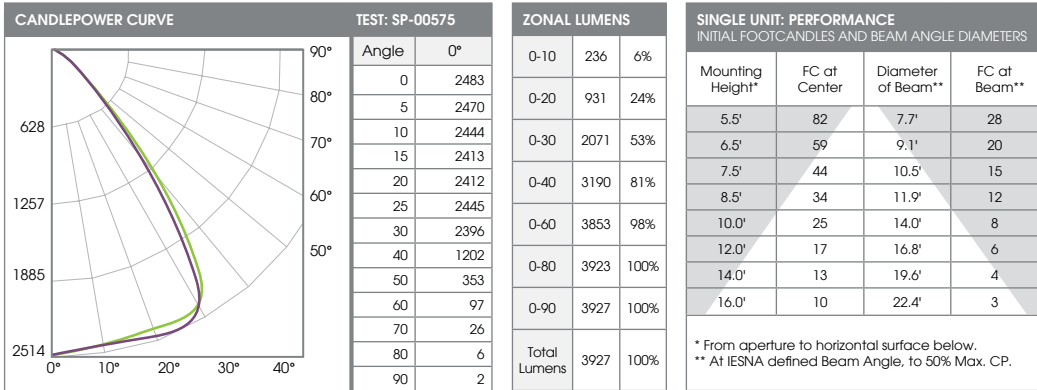

Green: 0-180  
Purple: 45-225

Delivered Lumens: 3927    CP @ 0° (Nadir): 2483  
Luminaire Watts: 39    Beam Angle: 70°  
LER: 101    CRI: 84

Spacing Ratio: 1.32  
Output Multipliers: 15L x 0.27, 27L x 0.49, 37L x 0.67

# COLOR OPTIONS - POWDER COAT PAINT FINISHES

NOTE: NO PRINTED IMAGE CAN EQUAL THE EXACT COLOR OF FINISH ON METAL.  
SEE INDIVIDUAL SPECIFICATION SHEETS OR CONSULT FACTORY FOR ADDITIONAL INFORMATION.



## STANDARD CORD / STEM / CANOPY FINISHES

FIXTURE COLOR	STANDARD CORD COLOR	STANDARD CANOPY / STEM COLOR
Matte White, Textured White	Matte White	Matte White
Gloss White	Matte White	Gloss White
Matte Black, Textured Black	Matte Black	Matte Black
All Others	Matte Black	Same Color as Fixture
Custom Color	Contact Factory	Contact Factory

## PAINT TIMES

TIER	COST	AVERAGE PAINT TIME*
Tier 1 - Standard Finishes	\$	⌚
Tier 2 - Typical Finishes	\$\$	⌚⌚
Custom Color	Contact Factory	Contact Factory

\*CONTACT FACTORY FOR SPECIFIC PRODUCT LEAD TIMES

## TIER 1 - STANDARD FINISHES

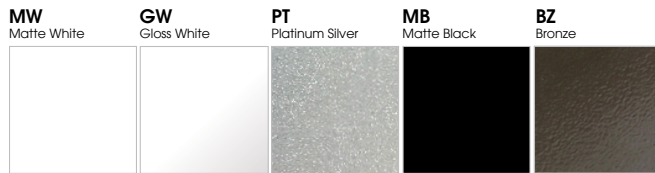

## TIER 2 - TYPICAL FINISHES



## CUSTOM COLOR FINISHES

CONTACT FACTORY

**CC**  
Custom Color



\*UNAVAILABLE FOR WET LOCATION