



Disconnect Power at electrical panel prior to installation and maintenance. Install in accordance with local regulations and National Electric Code by a person familiar with the construction and operation of the product and the hazards involved. Use only mating parts and accessories supplied by Spectrum Lighting.

• **INSTRUCTIONS FOR RECESSED REMOTE (RRM) EMERGENCY AND NON-EMERGENCY SKU'S.**

• **(RRM) IS NOT IC RATED; DO NOT INSTALL INSULATION WITHIN 76mm (3 in.) OF ANY PART OF THE LUMINAIRE.**

• **(RRM) IS INHERENTLY PROTECTED.**

• **ABOVE CEILING ACCESS REQUIRED BEFORE AND AFTER INSTALLATION.**

• **INSTALL ON CEILING FROM 0 TO 40° RELATIVE TO FLOOR.**

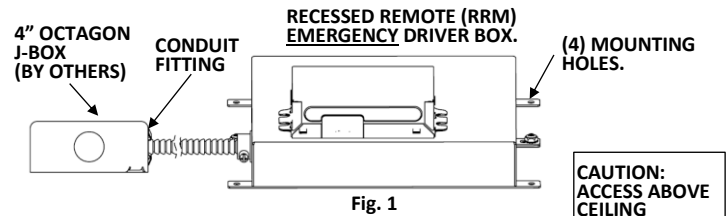

Fig. 1

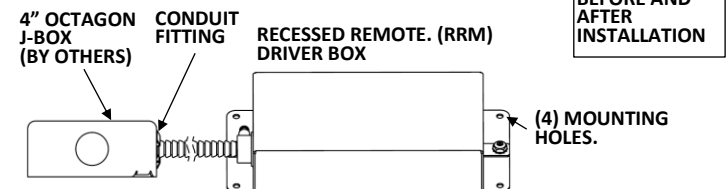

Fig. 2

1. **INSTALL RECESSED REMOTE BOX. Fig. 1,2**

- Pass wire through knock out and connect CONDUIT FITTING into J-BOX knock out.
- Secure DRIVER BOX to building structure using suitable hardware (By others).

2. **CUT STEM TO LENGTH (OPTIONAL) Fig. 3**

- Cut STEM to desired length. Note INTERNAL THREAD is needed.
- Drill .125 (1/8") diameter hole .25 (1/4") from cut end of STEM on center of STEM.
- Remove burrs and sharp edges.

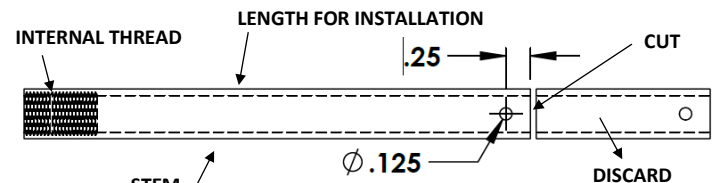

Fig. 3

3. **ASSEMBLE BALL AND BRACKETS TO STEM. Fig. 4**

- Assemble BALL to STEM and secure with SET SCREW. **SET SCREW must go into STEM HOLE. Fig. 5**
- Slide BRACKET on STEM in orientation shown.
- Slide CAGE onto BRACKET and over BALL.
- Snap BUSHING onto CAGE.

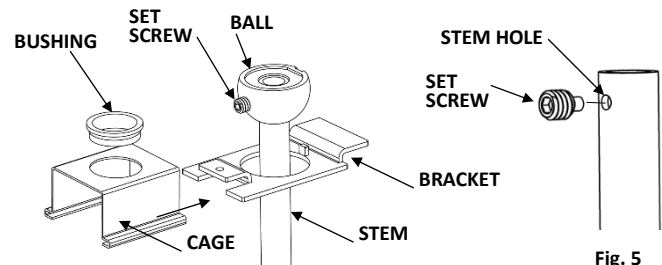

Fig. 4

Fig. 5

4. **INSTALL STEM TO BODY. Fig. 6**

- Pass STEM through CANOPY hole in orientation shown.
- Pass CORD through STEM and through BUSHING.
- Screw STEM onto THREADED BUSHING until tight.
- Cut and strip cord and wires if needed.
- For EM option Install EM SWITCH on CANOPY.

5. **INSTALL CROSSBAR TO J-BOX. Fig. 7**

- Orient MAGNETS away from J-BOX.
- For EM option: pass EM SWITCH WIRE through KEY HOLE, out of knock out and plug into BATTERY.
- Bring all other wires through center of CROSSBAR.
- Secure CROSSBAR to J-BOX using two screws.

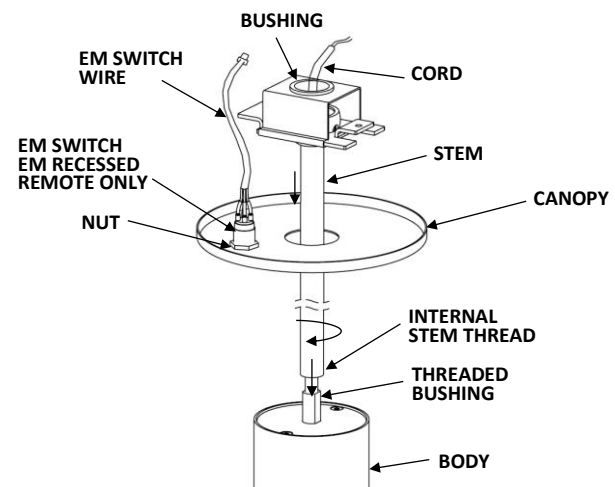

Fig. 6

**6. WIRE RRM TO PROPER SUPPLY VOLTAGE INSIDE J-BOX USING SUITABLE WIRE CONNECTORS (BY OTHERS).**

- Connect supply ground wire to CROSSBAR ground wire and RRM (Recessed Remote) green wire.
- Connect white neutral supply to RRM white wire.
- Connect black SWITCHED hot supply to RRM black wire.
- Connect led (-) black from CORD to led (-) blue RRM.
- Connect led (+) white from CORD to led (+) red RRM.
- For EM version only: Connect orange RRM wire to UNSWITCHED hot supply wire.

EMERGENCY OPTION.

Fig. 7

FOR 0-10V DIMMING.

- Connect RRM pink wire with control system pink or grey wire.
- Connect RRM Purple wire to control system purple wire.

ELV AND TRIAC DIMMING.

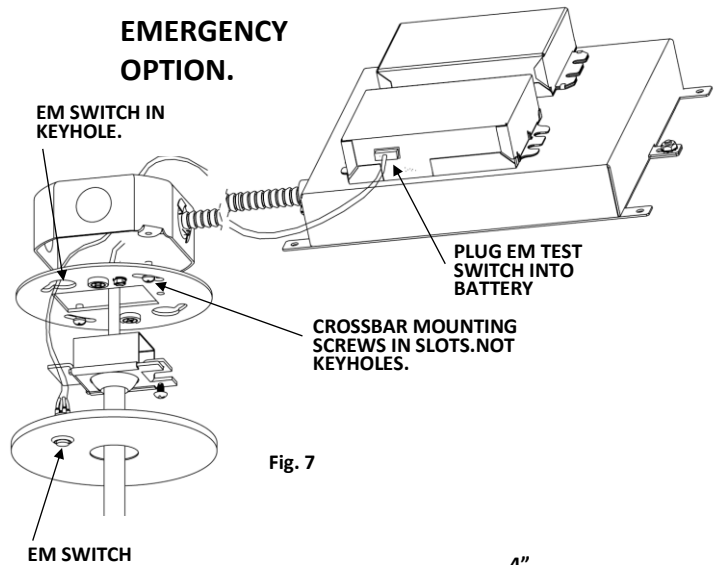
- Follow dimmer wiring diagram connect RRM white and black leads to dimming leads.

Cap RRM control wires pink and purple separately if they are not being used.

LUTRON RRM CONTROL WIRES (2) PURPLE

- Connect (1) RRM purple wire to (1) control system purple wire.
- Connect other RRM purple wire to other control system purple wire.

Place all splices in J-BOX.

7. INSTALL STEM ONTO CROSSBAR. Fig. 8,9.

NOTE ORIENTATION OF BRACKET TO CROSSBAR.

- Place BRACKET flange without hole over CROSSBAR.
- Pivot other side of BRACKET into CROSSBAR.
- Slide BRACKET and secure with LOCKING SCREW.

8. PUSH CANOPY AGAINST CROSSBAR UNTIL CANOPY ENGAGES MAGNETS. Fig. 10

NOTE: For EM version, pass EM SWITCH through KEYHOLE in CROSSBAR.

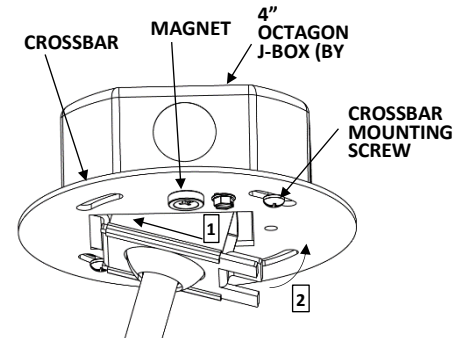

Fig. 8

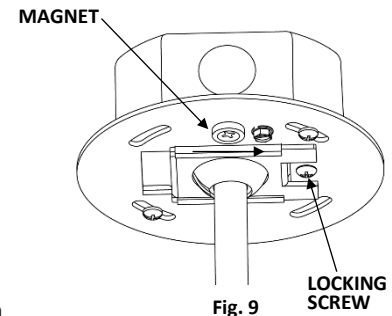

Fig. 9

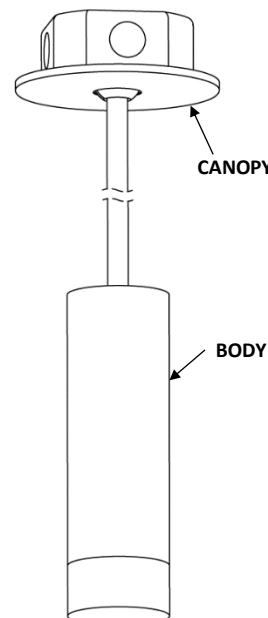

Fig.10